

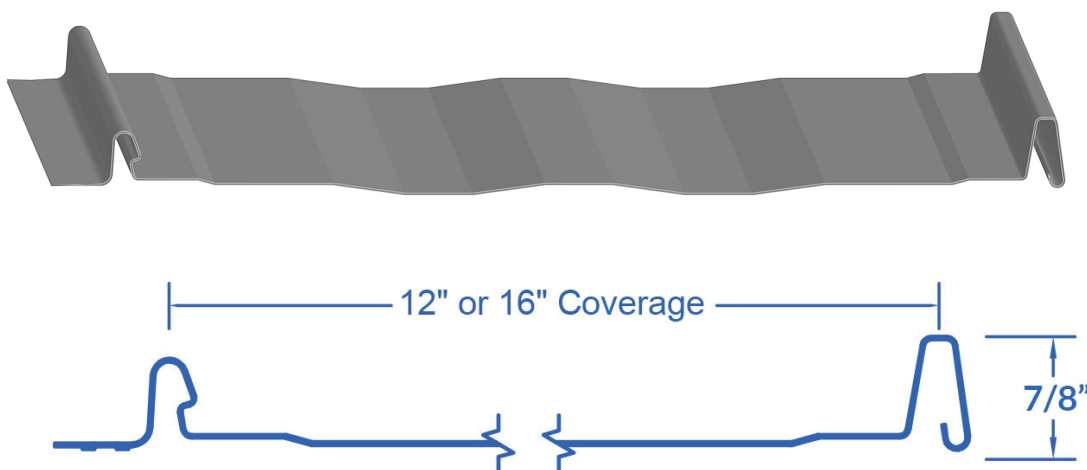

## FormaLoc Installation



The FormaLoc panel system is a hidden fastener standing seam panel that offers easy installation for roofers and DIY homeowners alike. Available with striations or minor ribs, FormaLoc works well for both roof (26 ga) or side panel applications. With long clean lines, this panel system provides recognized standing seam performance, while remaining an affordable product for a wide array of projects. Forma Loc should always be applied over solid substrate.

**FormaLoc Trims:** Refer to our FormaLoc Trim Series for a complete installation.

**Substrate:**

Walls: 1/2" Standard Plywood Minimum

Roof: 5/8" Standard Plywood Minimum

**Installation Drawings:** Basic installation drawings are attached to this document. Specific details and further information may be required as per site requirements.

**FORMA STEEL**

(403) 553-3896 | [orders@formasteel.ca](mailto:orders@formasteel.ca) | [formasteel.ca](http://formasteel.ca)

## Obstacle Removal

Remove downspouts to create a clear workspace for installing the siding. Trees, shrubs and any other objects that could get in the way should also be safely removed. Remove windowsill extensions where necessary.

## Roof Preparation

Ensure that the surface is even. The working surface should be secured with fasteners, and clear of debris such as old paint, putty or caulking buildup. Make sure the house wrap or water barrier is installed according to building codes before installing the panels over top.

## Product Preparation:

Remove the protective film prior to installation. Review panel lengths in reference to the cut sheet.

## Cutting:

Because the underside is flatter, it is recommended that roofing and siding be cut from this side. A power saw, nibbler, snips or profile shear may be used. Be sure to clean metal filings from off the panels to prevent unsightly stains.

## Storage Instructions:

If the panels are not going to be used immediately, they should be stored in a dry well ventilated area. If it is not possible to store the material inside, block up the panels to allow air movement around the packages. Also raise one side of the bundles to ensure positive draining, and use a good quality cover (other than plastic) anchored loosely to protect the material and still allow ventilation. Store away from aggressive substances and any other materials that could contaminate the surface of the panels.

## Application Precautions:

Metal installed with screw fasteners should be fastened onto a solid backing. Avoid installing directly over green, damp or ACQ lumber, porous insulation or other damaging materials. The use of a moisture barrier (such as Ice & Water Shield) is recommended in such situations. Strong chemicals, fertilizers, manure, some soils, and lime may cause premature deterioration. Installation near such materials is not recommended.

## Warning:

Material is slippery and has sharp edges, use extreme caution when handling or installing. Avoid working with sheet metal products on windy days.

## FormaLoc Installation Tools Available:

Forma Steel has many tools available for rent to make sure every installation goes as easy as possible. Below are our available tools for installing standing seam panels. Contact our Forma Steel Order Desk to reserve a trailer or tools for your next panel installation.



## SNAPTABLE PRO

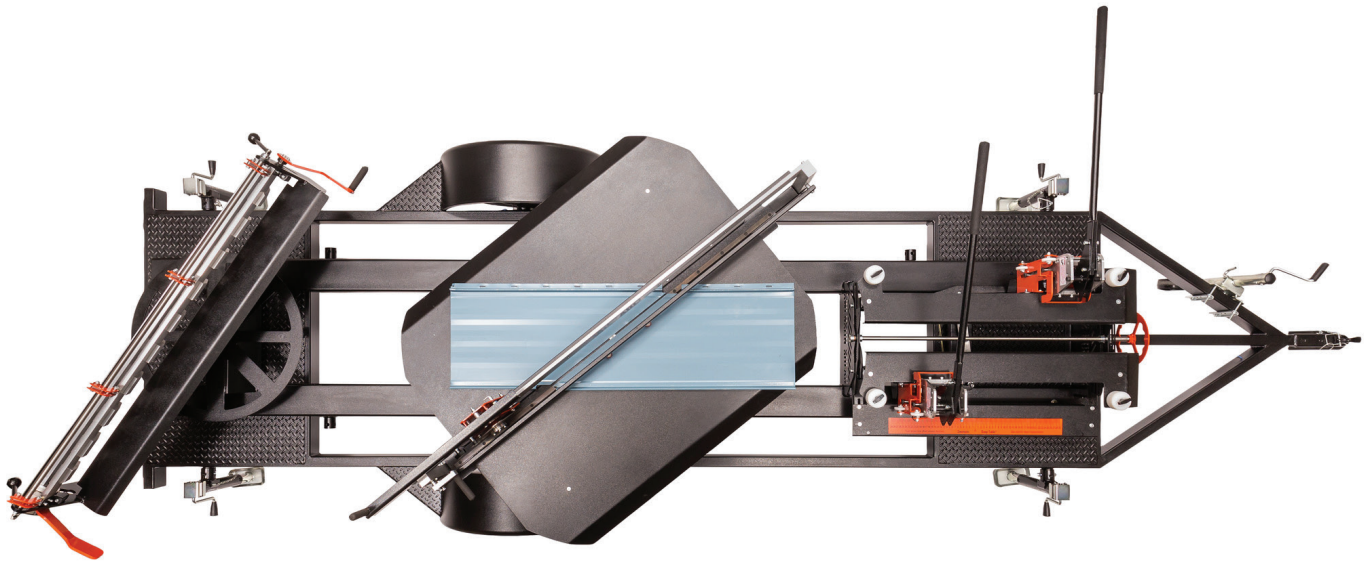

The Swenson Shear SnapTable Pro is an all-in-one panel system for preparing to install standing seam metal roofing. This tool is designed to perfect and speed-up your panel preparation process while producing factory like cuts.

This complete system is made up of 3 key components: the standing seam notcher, the panel cutter, and the eave and valley hemmer.

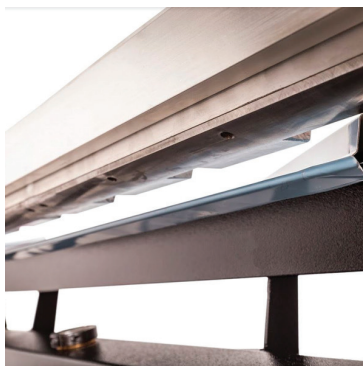

The Towable SnapTable Pro provides the highest quality notching, cutting and hemming for any commercial, industrial or residential job. It is equipped to notch, cut & hem your snap lock and standing seam profiles at your eaves, hips and valleys.

Contact Forma Steel for rental pricing and availability.

**FORMA STEEL**

(403) 553-3896 | [orders@formasteel.ca](mailto:orders@formasteel.ca) | [formasteel.ca](http://formasteel.ca)



## THERMAL GAP INSTALLATION CHART

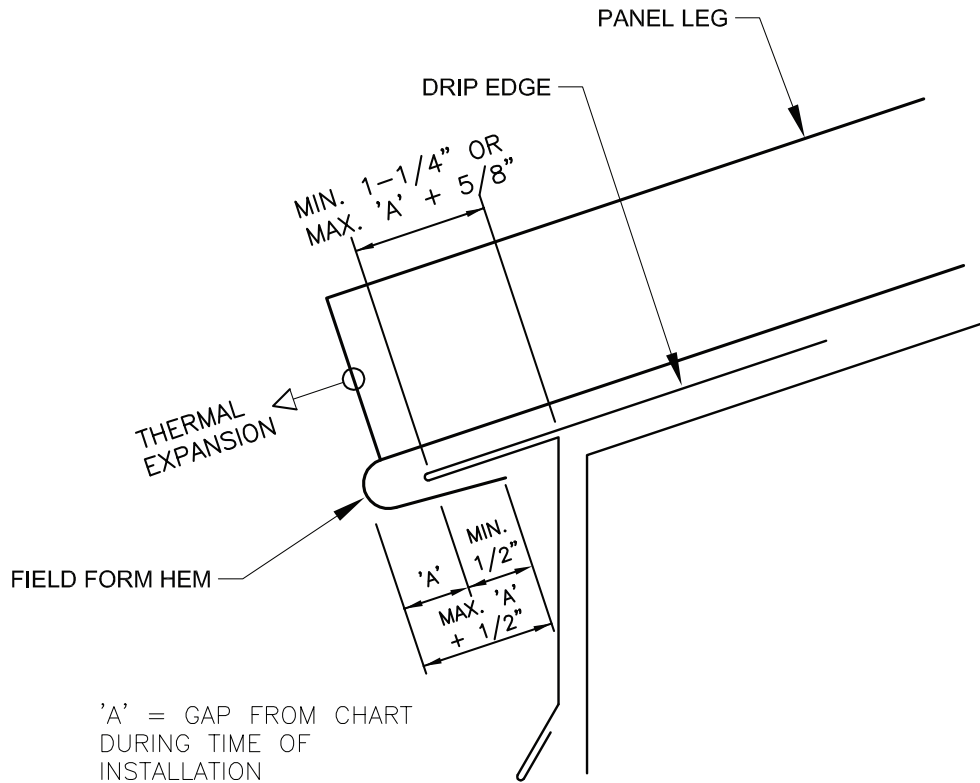

### THERMAL "GAP" INSTALLATION CHART (In inches) - ALUMINUM

For determining proper expansion/contraction gap at panel ends during installation

Distance from fixed point in feet	Material Temperature (Surface Temperature) During Installation					
	Hot		Warm		Cold	
	>100° F		100° to 50° F		<50° F	
10	0.279	1/4	0.139	1/8	0.000	0
20	0.557	9/16	0.279	1/4	0.000	0
30	0.836	13/16	0.418	7/16	0.125	1/8
40	1.115	1 1/8	0.557	9/16	0.125	1/8
50	1.393	1 3/8	0.697	11/16	0.188	3/16
60	1.672	1 11/16	0.836	13/16	0.188	3/16
70	1.950	1 15/16	0.975	1	0.250	1/4
80	2.229	2 1/4	1.115	1 1/8	0.250	1/4
90	2.508	2 1/2	1.254	1 1/4	0.375	3/8
100	2.786	2 13/16	1.393	1 3/8	0.375	3/8

\* Chart based on temperature differential of: 180 degrees F

\* Coefficient of thermal expansion for alum.: 0.0000129

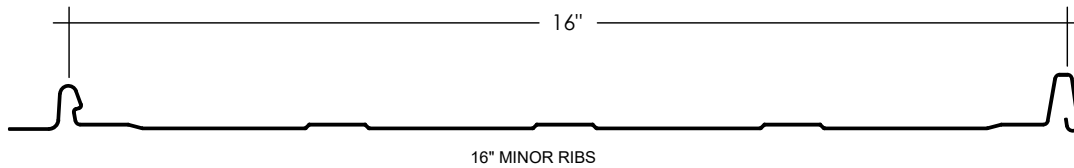
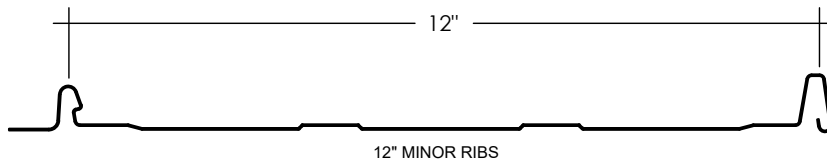
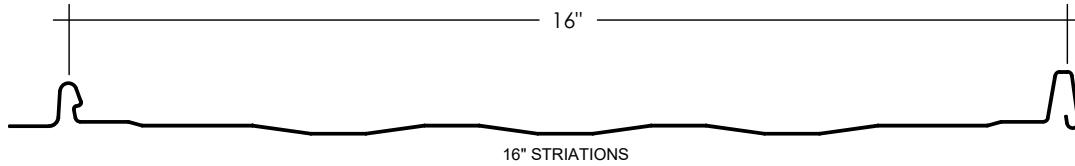
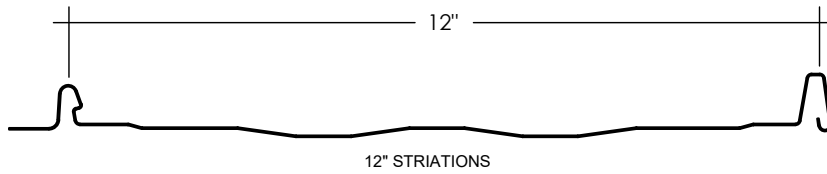

						APP
						CHK
						DRW
						DSN
						DRAWING STATUS
						DATE (YY/MM/DD)
						#

# NOTES

This is a copyright drawing and shall not be reproduced in any form without written permission from Forma Steel

Contractor to check and verify all the dimensions before construction, any errors and omissions shall be reported immediately

Do not scale the drawing

All construction shall be in accordance with latest codes.

NOTES:  
LIGHT GAUGE STEEL CLADDING WITH WIDE FLAT PANS MAY EXHIBIT OIL CANNING WHICH CAN AFFECT THE AFFECT THE AESTHETICS OF THE BUILDING DESIGN

OIL CANNING WILL VARY DEPENDING ON THE TIME OF DAY AND ANGLE OF VIEWING AND IS USUALLY MORE NOTICEABLE IN DARKER COLOURS

OIL CANNING WILL ALSO BE MORE PREVALENT IN WIDER PANS AND LONGER SHEET RUNS, BUILDING DESIGNERS AND HOMEOWNERS SHOULD BE AWARE OF THIS AND TAKE INTO CONSIDERATION

OIL CANNING IS NOT A REASON FOR MATERIAL REJECTION

	NAME	SIGNATURE	DATE
OWNER APPROVAL:			
CONTRACTOR APPROVAL:			
CONSULTANT APPROVAL:			
PROJECT	FORMA LOC	DRAWING	PANEL DRAWING

DATE	SHEET NUMBER
	SD1

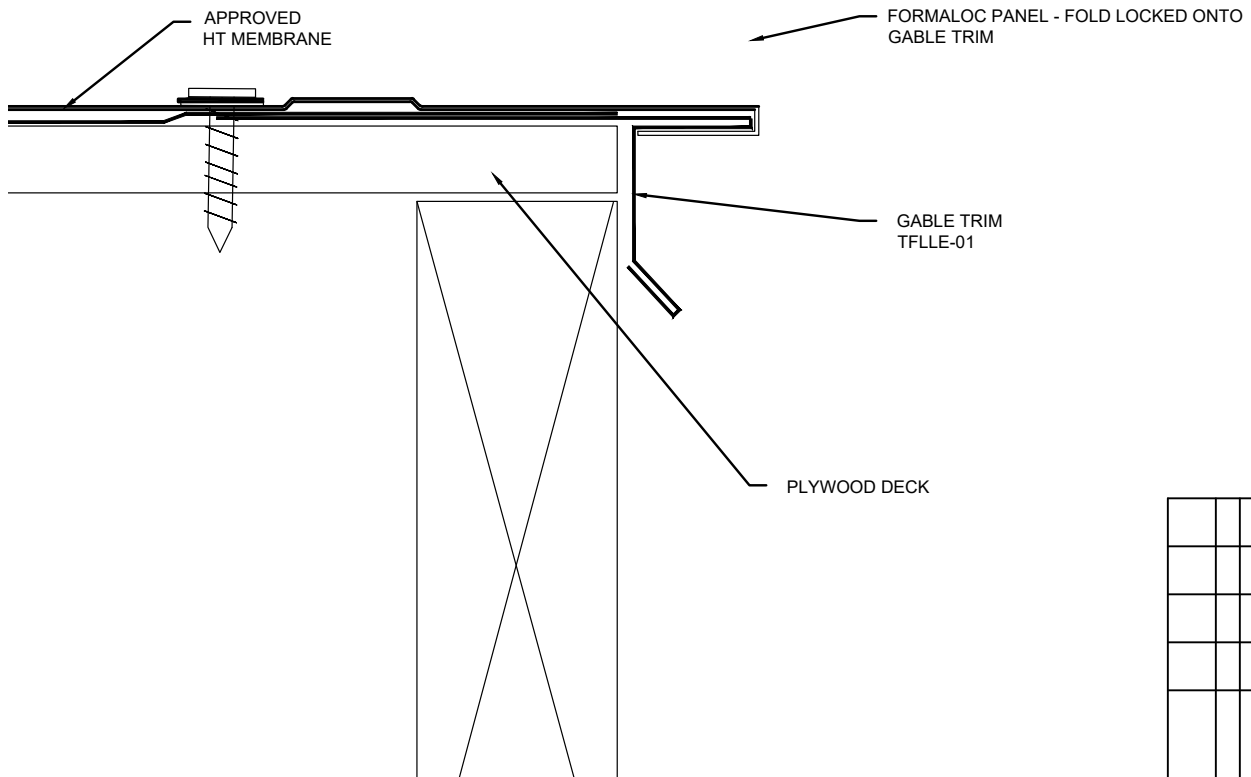

					APP
					CHK
					DRW
					DSN
					DRAWING STATUS
					DATE (YY/MM/DD)
					#

#### NOTES

This is a copyright drawing and shall not be reproduced in any form without written permission from Forma Steel

Contractor to check and verify all the dimensions before construction, any errors and omissions shall be reported immediately

Do not scale the drawing

All construction shall be in accordance with latest codes.

	NAME	SIGNATURE	DATE
OWNER APPROVAL:			
CONTRACTOR APPROVAL:			
CONSULTANT APPROVAL:			

PROJECT	FORMA LOC	DRAWING	FOLDED GABLE
---------	-----------	---------	--------------

DATE	SHEET NUMBER
	SD2

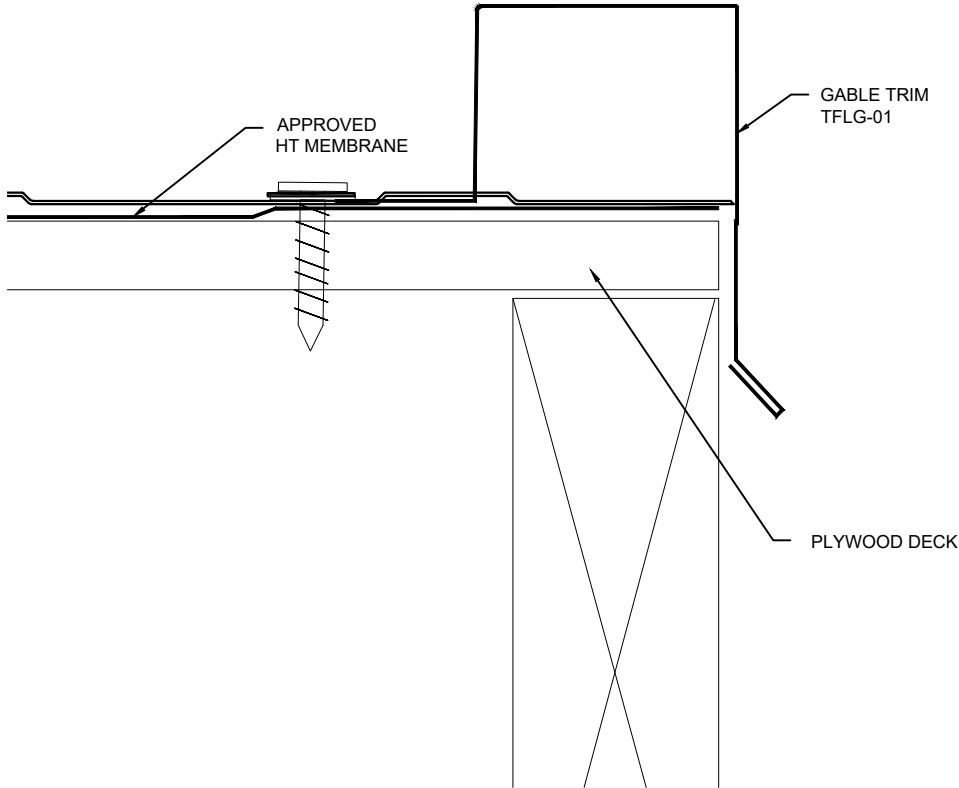

					APP
					CHK
					DRW
					DSN
					DRAWING STATUS
					DATE (YY/MM/DD)
					#

#### NOTES

This is a copyright drawing and shall not be reproduced in any form without written permission from Forma Steel

Contractor to check and verify all the dimensions before construction, any errors and omissions shall be reported immediately

Do not scale the drawing

All construction shall be in accordance with latest codes.

	NAME	SIGNATURE	DATE
OWNER APPROVAL:			
CONTRACTOR APPROVAL:			
CONSULTANT APPROVAL:			

PROJECT	FORMA LOC	DRAWING	STANDARD GABLE
---------	-----------	---------	----------------

DATE	SHEET NUMBER
	SD3

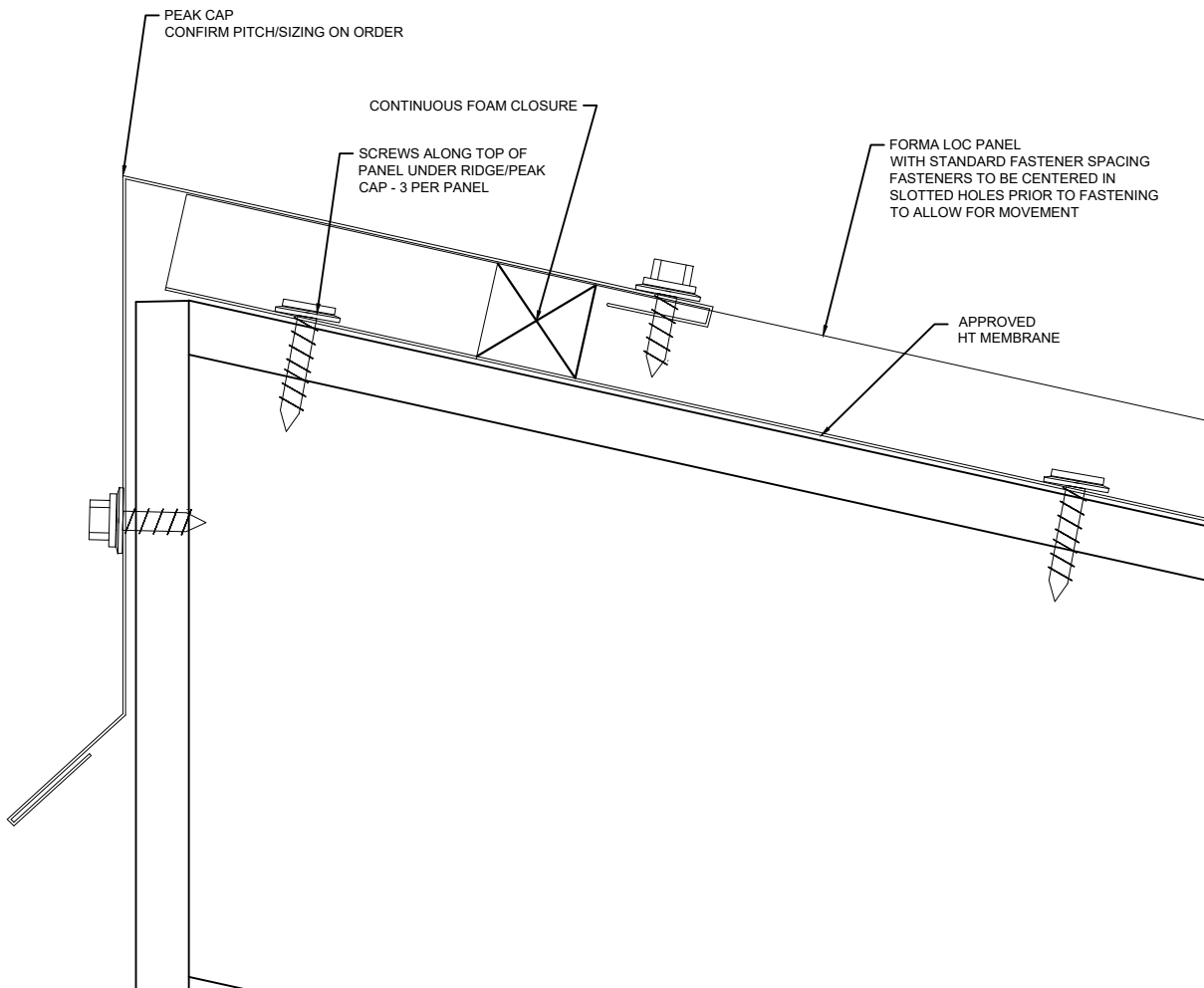

					APP
					CHK
					DRW
					DSN
					DRAWING STATUS
					DATE (YY/MM/DD)
					#

### NOTES

This is a copyright drawing and shall not be reproduced in any form without written permission from Forma Steel

Contractor to check and verify all the dimensions before construction, any errors and omissions shall be reported immediately

Do not scale the drawing

All construction shall be in accordance with latest codes.

	NAME	SIGNATURE	DATE
OWNER APPROVAL:			
CONTRACTOR APPROVAL:			
CONSULTANT APPROVAL:			

PROJECT	FORMA LOC	DRAWING	HIGH EAVE
---------	-----------	---------	-----------

DATE	SHEET NUMBER <b>SD4</b>
------	----------------------------



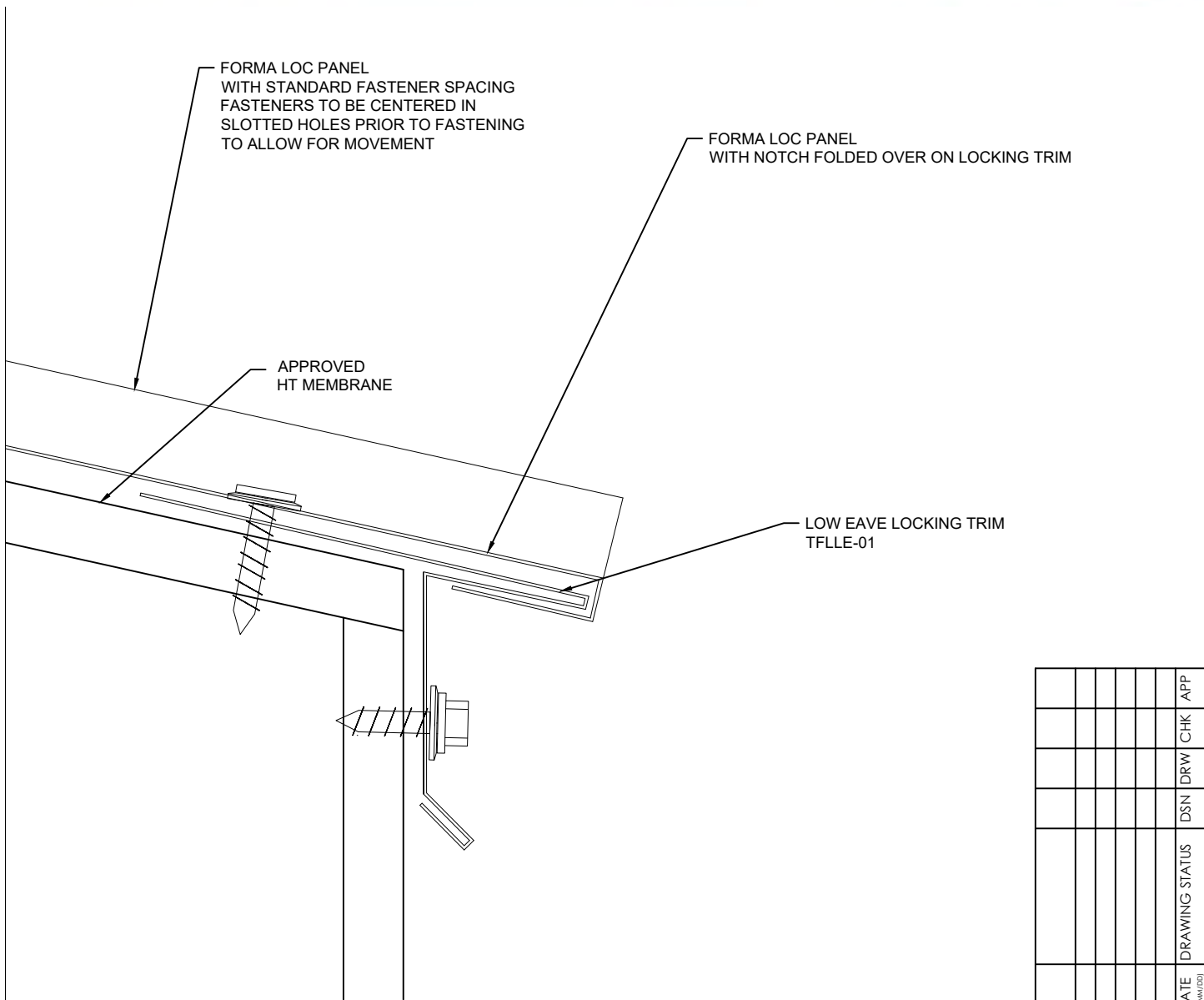

					APP
					CHK
					DRW
					DSN
					DRAWING STATUS
					DATE (YY/MM/DD)
					#

### NOTES

This is a copyright drawing and shall not be reproduced in any form without written permission from Forma Steel

Contractor to check and verify all the dimensions before construction, any errors and omissions shall be reported immediately

Do not scale the drawing

All construction shall be in accordance with latest codes.

	NAME	SIGNATURE	DATE
OWNER APPROVAL:			
CONTRACTOR APPROVAL:			
CONSULTANT APPROVAL:			

PROJECT	DRAWING
FORMA LOC	LOCKING LOW EAVE

DATE
------

SHEET NUMBER
SD5

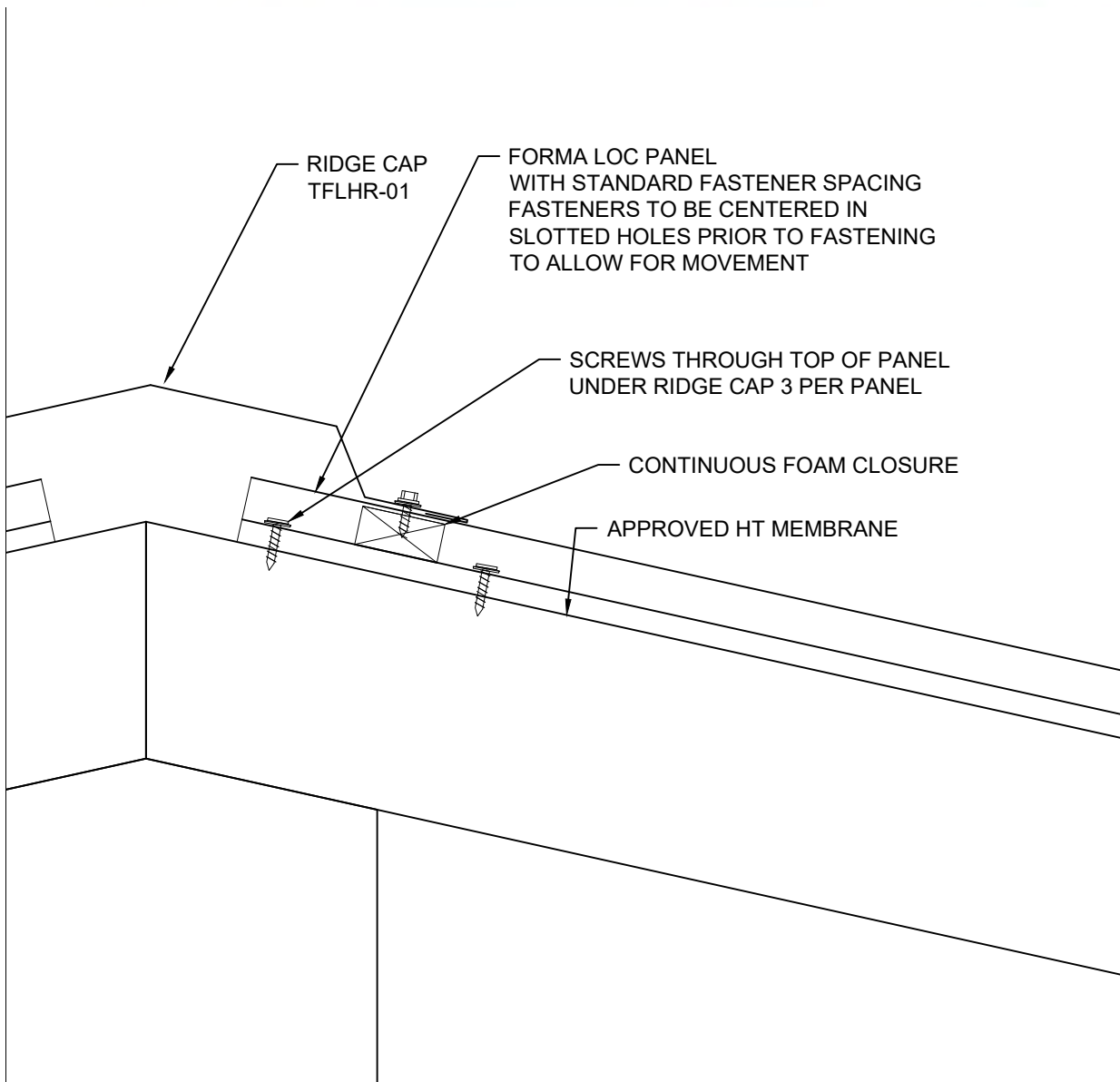

						APP
						CHK
						DRW
						DSN
						DRAWING STATUS
						DATE (YY/MM/DD)
						#

#### NOTES

This is a copyright drawing and shall not be reproduced in any form without written permission from Forma Steel

Contractor to check and verify all the dimensions before construction, any errors and omissions shall be reported immediately

Do not scale the drawing

All construction shall be in accordance with latest codes.

	NAME	SIGNATURE	DATE
OWNER APPROVAL:			
CONTRACTOR APPROVAL:			
CONSULTANT APPROVAL:			

PROJECT	FORMA LOC	DRAWING	VENTED RIDGE
---------	-----------	---------	--------------

DATE	SHEET NUMBER
	SD6

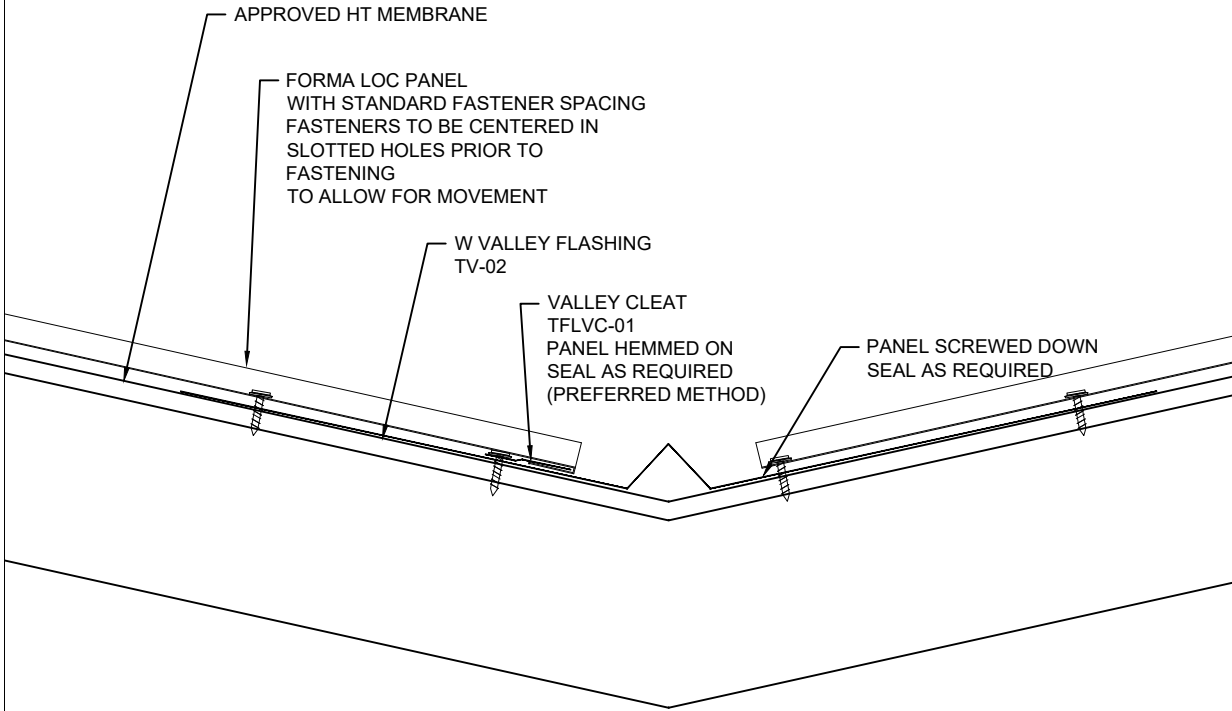

					APP
					CHK
					DRW
					DSN
					DRAWING STATUS
					DATE (YY/MM/DD)
					#

#### NOTES

This is a copyright drawing and shall not be reproduced in any form without written permission from Forma Steel

Contractor to check and verify all the dimensions before construction, any errors and omissions shall be reported immediately

Do not scale the drawing

All construction shall be in accordance with latest codes.

	NAME	SIGNATURE	DATE
OWNER APPROVAL:			
CONTRACTOR APPROVAL:			
CONSULTANT APPROVAL:			

PROJECT	FORMA LOC	DRAWING	VALLEY FLASHING
---------	-----------	---------	-----------------

DATE	SHEET NUMBER <b>SD7</b>
------	----------------------------