



Forma Plank Installation

6-1/4" Coverage



8-1/2" Coverage



Forma Plank Features and Properties

The Forma Plank Panel is available in both 6-1/4" coverage and 8-1/2" coverage with a 1" panel reveal. Forma Plank is available in all of our standard 24 Gauge colours including our Woodgrain Series, Textured Steel Series and our PVDF Colour Series.

Installing Forma Plank:

Forma Plank is designed for wall applications with a concealed floating clip system to allow for thermal expansion and contraction. Forma Plank can be installed both horizontally and vertically, in varying widths, and is easily integrated with standard cladding profiles.

Forma Plank Trims: Refer to our 7/8" Trim Collection for all trim profiles associated with Forma Plank.

Install using Clips: Please use a Clip Spacing of 24".

Substrate: A minimum substrate of 1/2" plywood is recommended.

Please Note: Z-Bar is strongly recommended to reduce the chance of oil canning.

Installation Drawings: Basic installation drawings are attached to this document. Specific details and further information may be required as per site requirements.

Obstacle Removal

Remove downspouts to create a clear workspace for installing the siding. Trees, shrubs and any other objects that could get in the way should also be safely removed. Remove windowsill extensions where necessary.

Wall Preparation

Ensure that the surface is even. You may have to shim out low places in the plane of the wall. The working surface should be secured with fasteners, and clear of debris such as old paint, putty or caulking buildup. Make sure the house wrap or water barrier is installed according to building codes before installing the siding over top.

Product Preparation:

Remove the protective film prior to installation. Review panel lengths in reference to the cut sheet. The system is designed to be installed from the bottom up.

Cutting:

Because the underside is flatter, it is recommended that roofing and siding be cut from this side. A power saw, nibbler, snips or profile shear may be used. Be sure to clean metal filings from off the panels to prevent unsightly stains.

Storage Instructions:

If the panels are not going to be used immediately, they should be stored in a dry well ventilated area. If it is not possible to store the material inside, block up the panels to allow air movement around the packages. Also raise one side of the bundles to ensure positive draining, and use a good quality cover (other than plastic) anchored loosely to protect the material and still allow ventilation. Store away from aggressive substances and any other materials that could contaminate the surface of the panels.

Application Precautions:

Metal installed with screw fasteners should be fastened onto a solid backing. Avoid installing directly over green, damp or ACQ lumber, porous insulation or other damaging materials. The use of a moisture barrier (such as Ice & Water Shield) is recommended in such situations. Strong chemicals, fertilizers, manure, some soils, and lime may cause premature deterioration. Installation near such materials is not recommended.

Warning:

Material is slippery and has sharp edges, use extreme caution when handling or installing. Avoid working with sheet metal products on windy days.

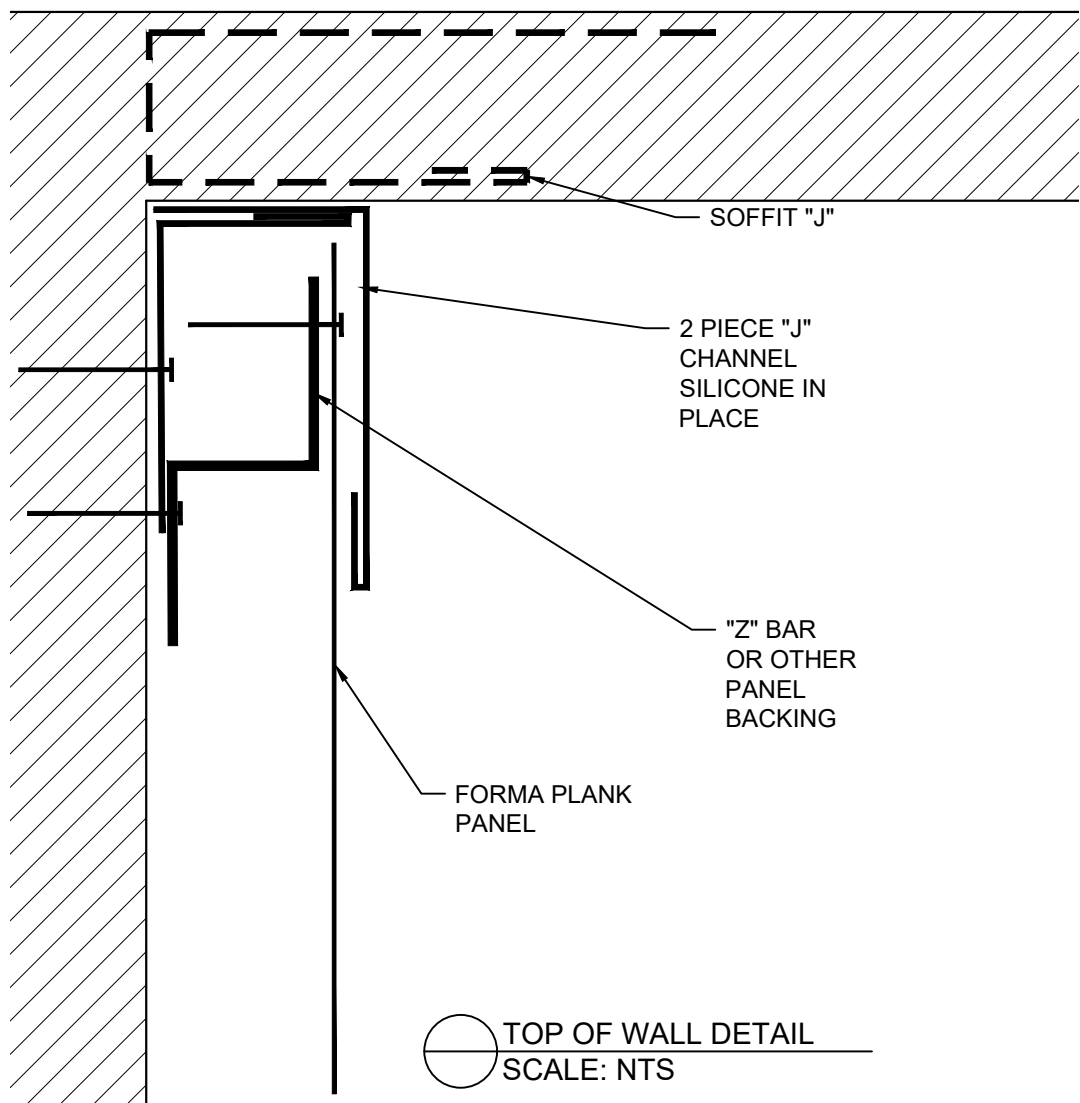

NOTE:
-SUBSTRATE MUST BE LEVEL, PLUMB AND IN PLANE.
-INSTALLATION OF CLIPS MUST NOT INDUCE OUTSIDE FORCES INTO THE PANEL
-Z BAR IS STRONGLY RECOMMENDED AS PANEL BACKING TO HELP REDUCE THE CHANCE OF OIL CANNING
-RECOMMENDED SUBSTRATE $\frac{1}{2}$ " PLYWOOD MINIMUM WITH A CLIP SPACING OF 24"

						APP
						CHK
						DRW
						DSN
						DRAWING STATUS
						DATE
						ITV/AM/COI
						#

NOTES

This is a copyright drawing and shall not be reproduced in any form without written permission from Forma Steel

Contractor to check and verify all the dimensions before construction, any errors and omissions shall be reported immediately

Do not scale the drawing

All construction shall be in accordance with latest codes.

SERIES	DRAWING
FORMA STEEL FORMA PLANK	TOP OF WALL

DATE
2021

SHEET NUMBER
D1

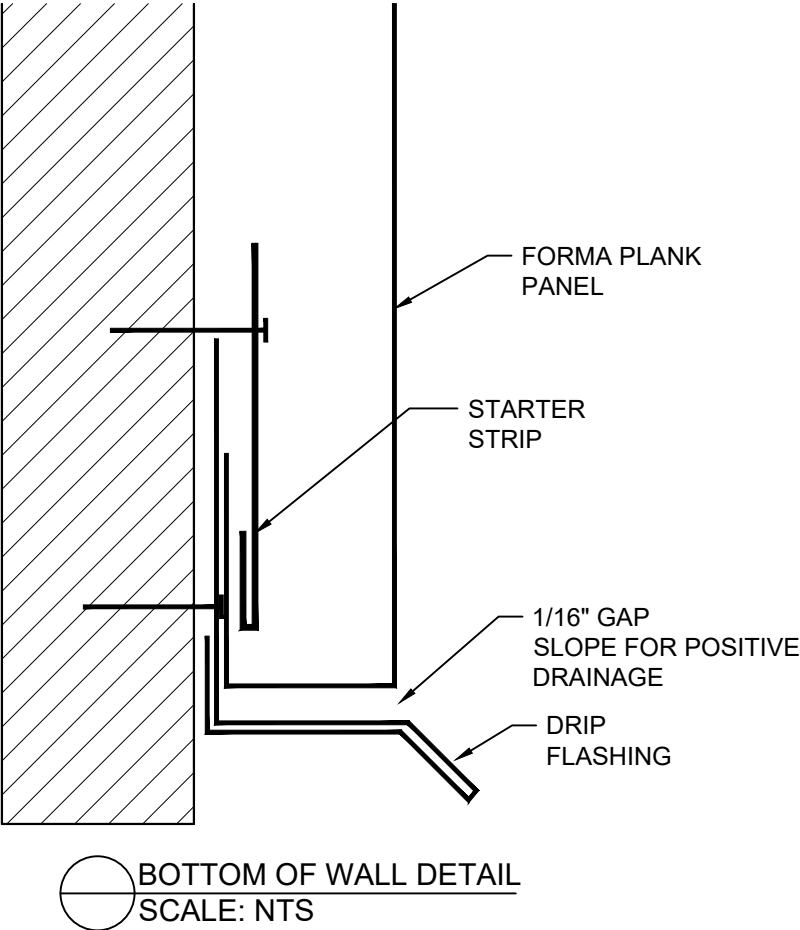

NOTE:
-SUBSTRATE MUST BE LEVEL, PLUMB AND IN PLANE.
-INSTALLATION OF CLIPS MUST NOT INDUCE OUTSIDE FORCES INTO THE PANEL
-Z BAR IS STRONGLY RECOMMENDED AS PANEL BACKING TO HELP REDUCE THE CHANCE OF OIL CANNING
-RECOMMENDED SUBSTRATE 1/4" PLYWOOD MINIMUM WITH A CLIP SPACING OF 24"

					APP
					CHK
					DRW
					DSN
					DRAWING STATUS
					DATE (YY/MM/DD)
					#

NOTES

This is a copyright drawing and shall not be reproduced in any form without written permission from Forma Steel

Contractor to check and verify all the dimensions before construction, any errors and omissions shall be reported immediately

Do not scale the drawing

All construction shall be in accordance with latest codes.

SERIES	DRAWING
FORMA STEEL FORMA PLANK	BASE/DRIP FLASHING

DATE
2021

SHEET NUMBER
D2

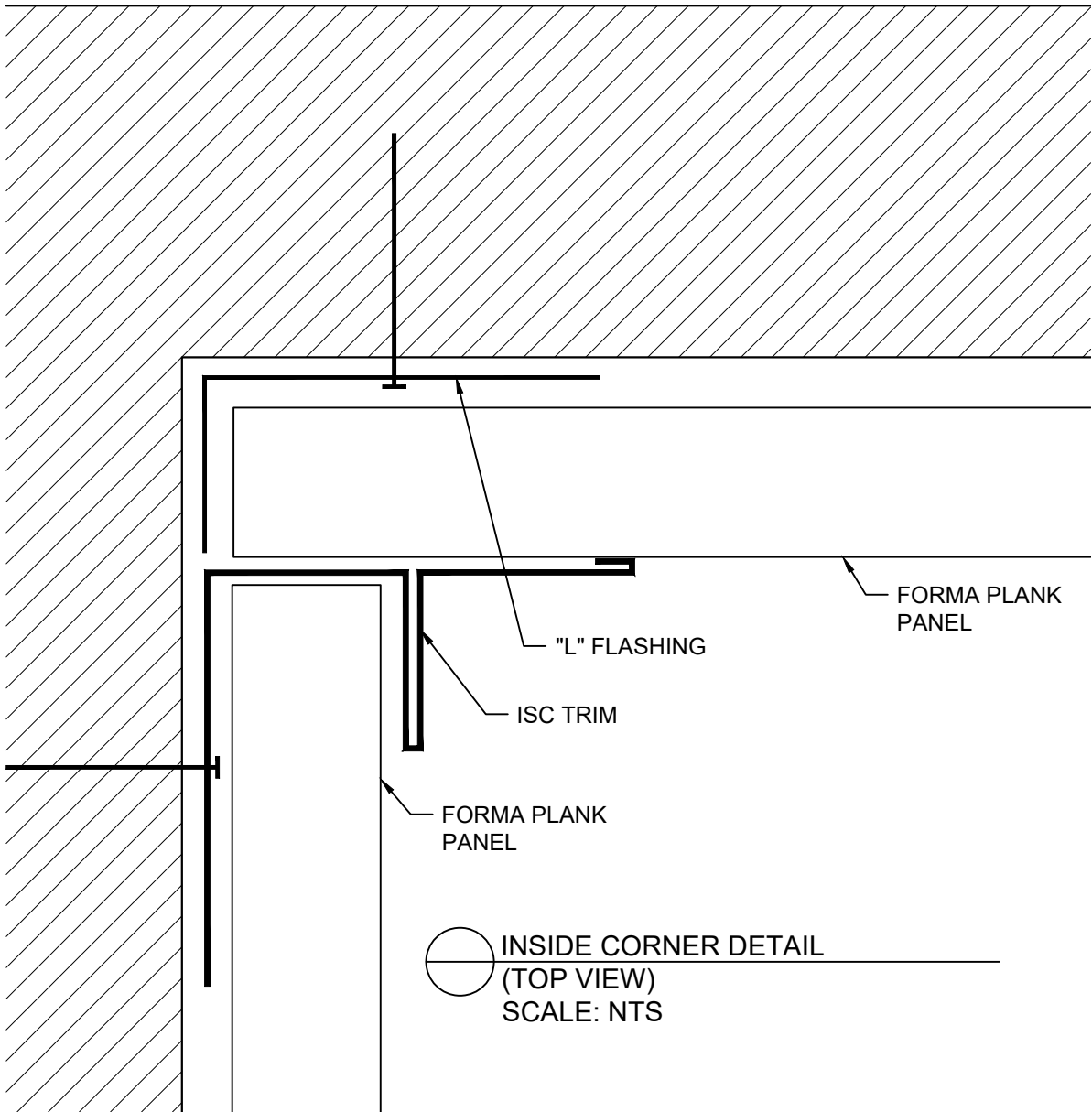

NOTE:
-SUBSTRATE MUST BE LEVEL, PLUMB AND IN PLANE.
-INSTALLATION OF CLIPS MUST NOT INDUCE OUTSIDE FORCES INTO THE PANEL
-Z BAR IS STRONGLY RECOMMENDED AS PANEL BACKING TO HELP REDUCE THE CHANCE OF OIL CANNING
-RECOMMENDED SUBSTRATE $\frac{1}{2}$ " PLYWOOD MINIMUM WITH A CLIP SPACING OF 24"

						APP
						CHK
						DRW
						DSN
						DRAWING STATUS
						DATE (YY/MM/DD)
						#

NOTES

This is a copyright drawing and shall not be reproduced in any form without written permission from Forma Steel

Contractor to check and verify all the dimensions before construction, any errors and omissions shall be reported immediately

Do not scale the drawing

All construction shall be in accordance with latest codes.

SERIES	DRAWING
FORMA STEEL FORMA PLANK	INSIDE CORNER

DATE
2021

SHEET NUMBER
D3

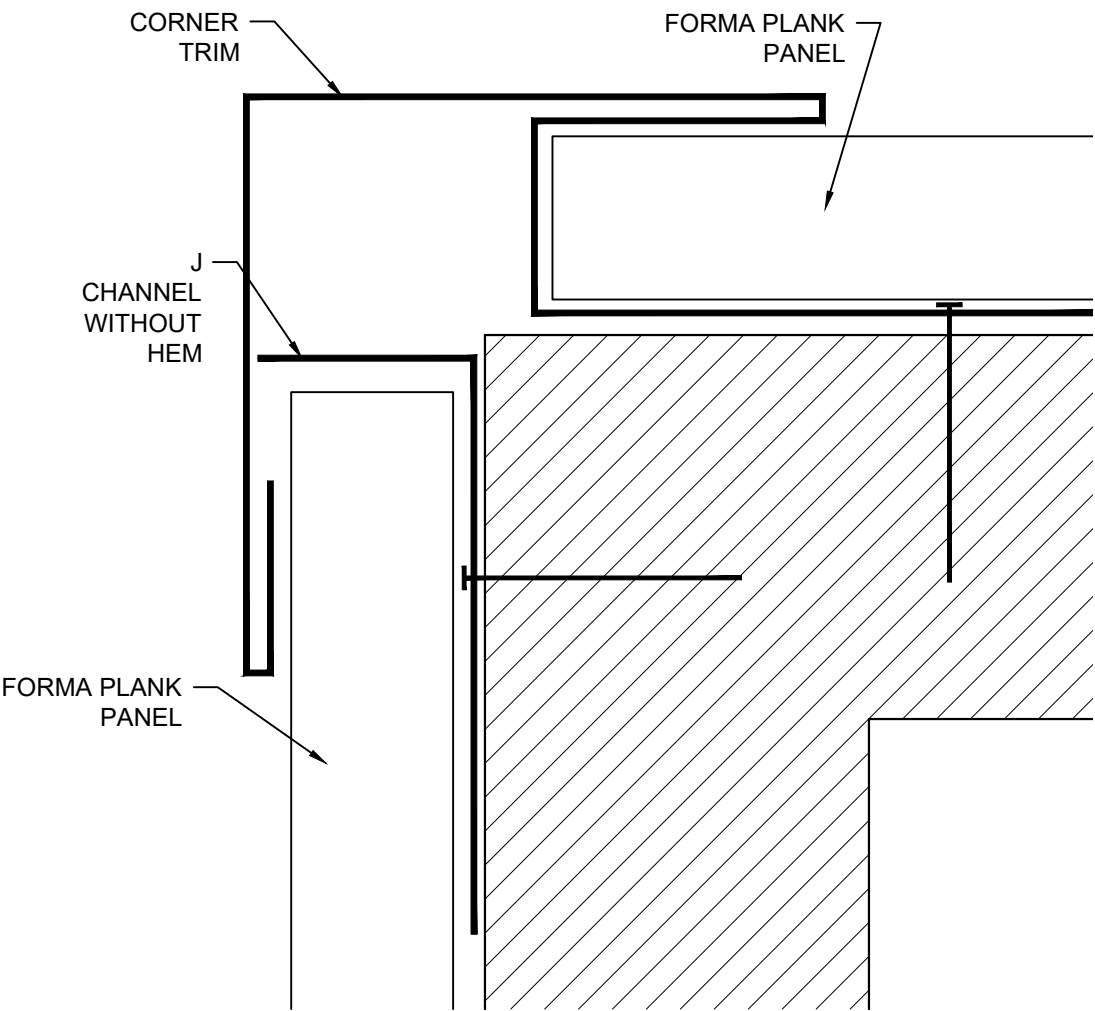

OUTSIDE CORNER DETAIL
(TOP VIEW)
SCALE: NTS

NOTE:
-SUBSTRATE MUST BE LEVEL, PLUMB AND IN PLANE.
-INSTALLATION OF CLIPS MUST NOT INDUCE OUTSIDE FORCES INTO THE PANEL
-Z BAR IS STRONGLY RECOMMENDED AS PANEL BACKING TO HELP REDUCE THE CHANCE OF OIL CANNING
-RECOMMENDED SUBSTRATE 1/2" PLYWOOD MINIMUM WITH A CLIP SPACING OF 24"

					APP
					CHK
					DRW
					DSN
					DRAWING STATUS
					DATE
					BY
					#

NOTES

This is a copyright drawing and shall not be reproduced in any form without written permission from Forma Steel

Contractor to check and verify all the dimensions before construction, any errors and omissions shall be reported immediately

Do not scale the drawing

All construction shall be in accordance with latest codes.

Forma Plank Installation

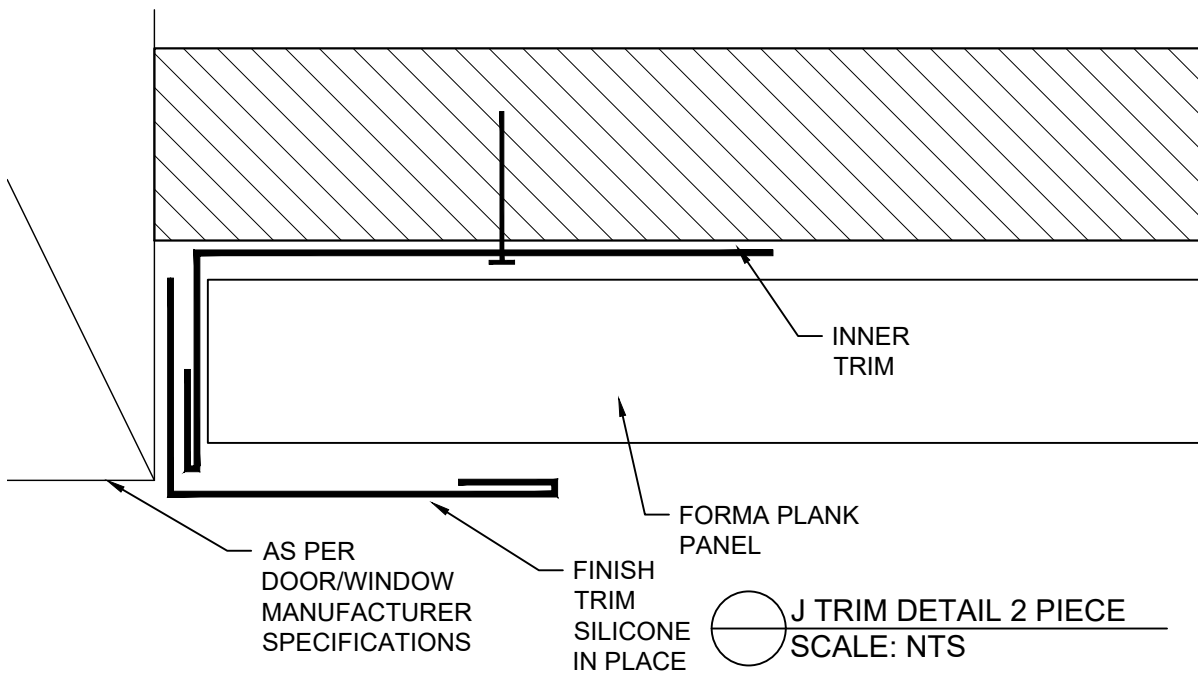
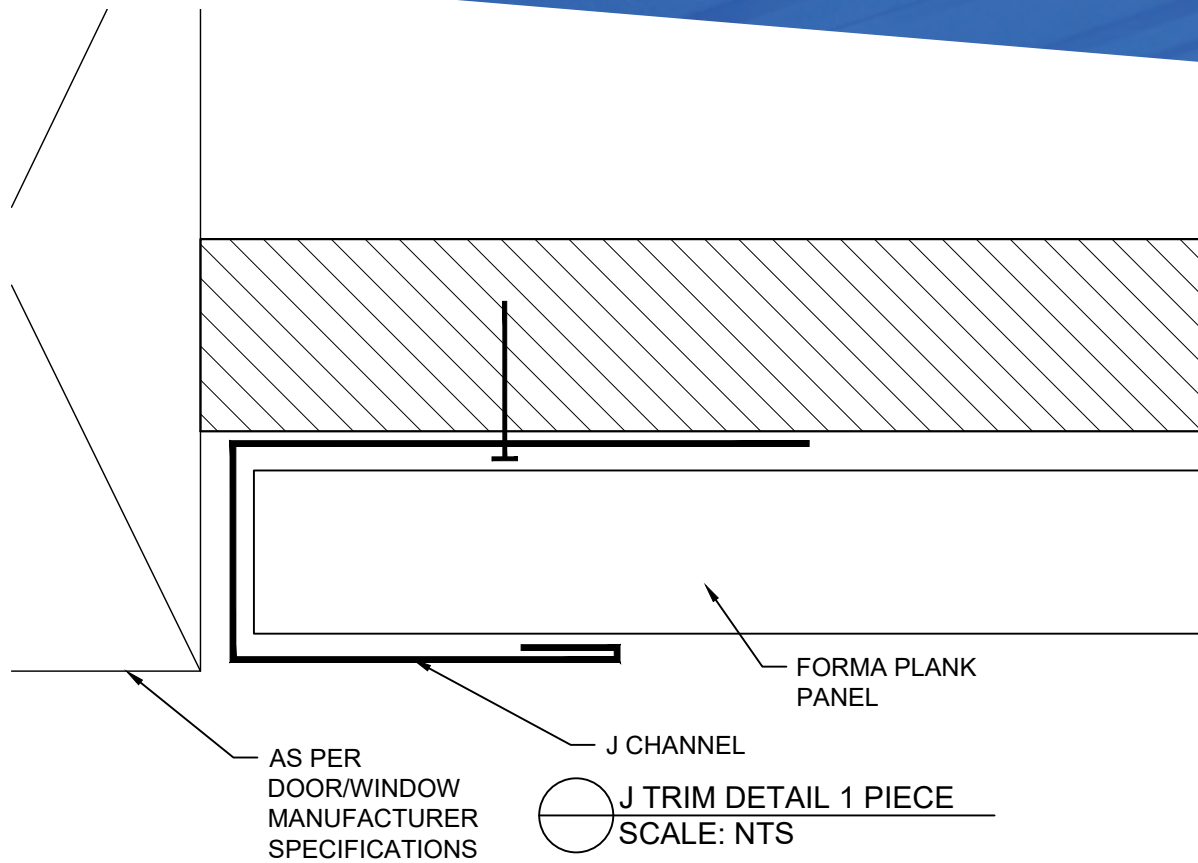

NOTE:
 -SUBSTRATE MUST BE LEVEL, PLUMB AND IN PLANE.
 -INSTALLATION OF CLIPS MUST NOT INDUCE OUTSIDE FORCES INTO THE PANEL
 -Z BAR IS STRONGLY RECOMMENDED AS PANEL BACKING TO HELP REDUCE THE CHANCE OF OIL CANNING
 -RECOMMENDED SUBSTRATE $\frac{1}{4}$ " PLYWOOD MINIMUM WITH A CLIP SPACING OF 24"

					APP
					CHK
					DRW
					DSN
					DRAWING STATUS
					DATE (YY/MM/DD)
					#

NOTES

This is a copyright drawing and shall not be reproduced in any form without written permission from Forma Steel

Contractor to check and verify all the dimensions before construction, any errors and omissions shall be reported immediately

Do not scale the drawing

All construction shall be in accordance with latest codes.

SERIES	DRAWING
FORMA STEEL FORMA PLANK	J TRIM

DATE
2021

SHEET NUMBER
D5

Forma Plank Installation

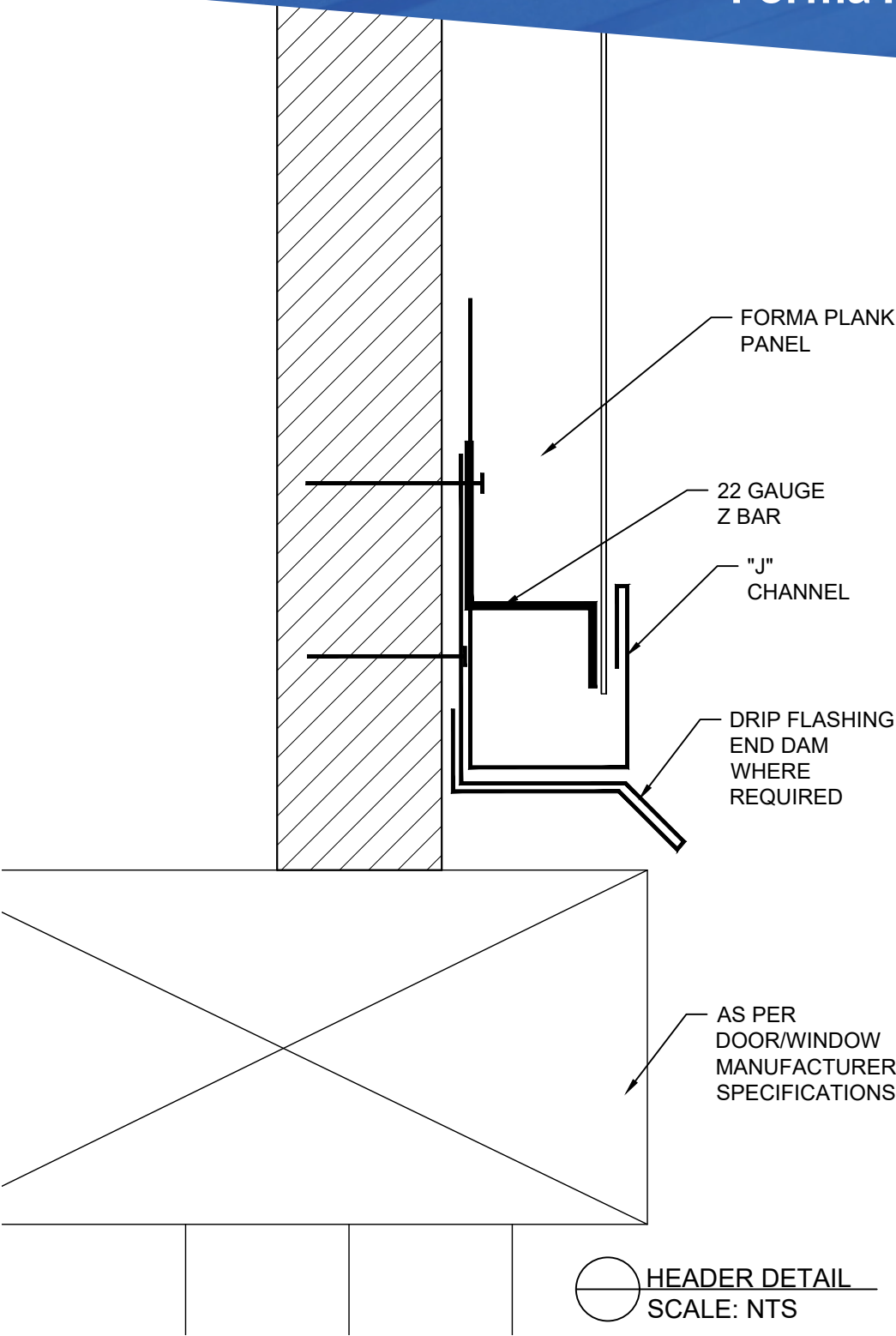

NOTE:
-SUBSTRATE MUST BE LEVEL, PLUMB AND IN PLANE.
-INSTALLATION OF CLIPS MUST NOT INDUCE OUTSIDE FORCES INTO THE PANEL
-Z BAR IS STRONGLY RECOMMENDED AS PANEL BACKING TO HELP REDUCE THE CHANCE OF OIL CANNING
-RECOMMENDED SUBSTRATE $\frac{1}{2}$ " PLYWOOD MINIMUM WITH A CLIP SPACING OF 24"

					APP
					CHK
					DRW
					DSN
					DRAWING STATUS
					DATE (YY/MM/DD)
					#

NOTES

This is a copyright drawing and shall not be reproduced in any form without written permission from Forma Steel

Contractor to check and verify all the dimensions before construction, any errors and omissions shall be reported immediately

Do not scale the drawing

All construction shall be in accordance with latest codes.

SERIES	DRAWING
FORMA STEEL FORMA PLANK	HEADER DETAIL

DATE
2021

SHEET NUMBER
D6

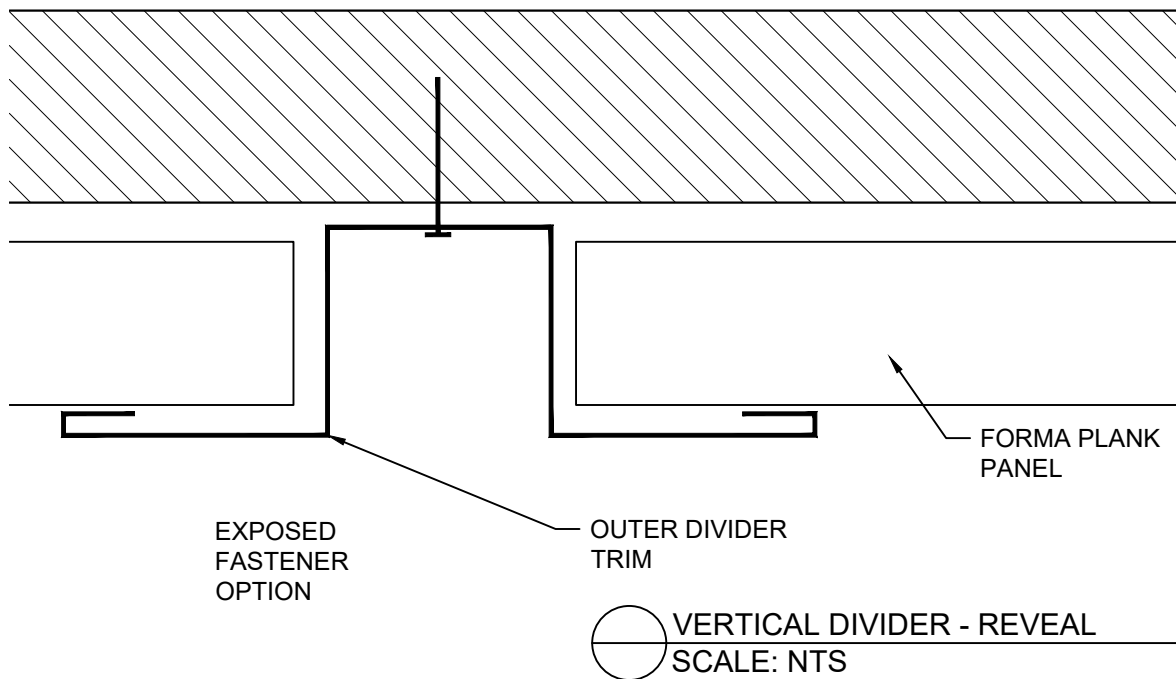
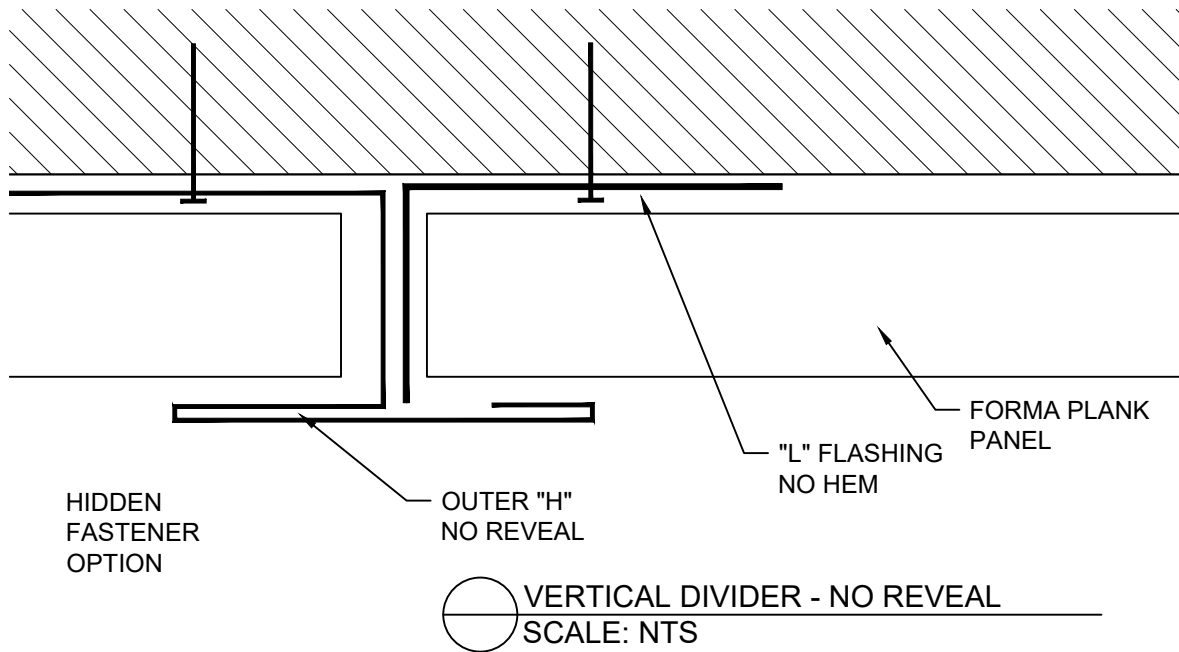

NOTE:
-SUBSTRATE MUST BE LEVEL, PLUMB AND IN PLANE.
-INSTALLATION OF CLIPS MUST NOT INDUCE OUTSIDE FORCES INTO THE PANEL
-Z BAR IS STRONGLY RECOMMENDED AS PANEL BACKING TO HELP REDUCE THE CHANCE OF OIL CANNING
-RECOMMENDED SUBSTRATE 1/2" PLYWOOD MINIMUM WITH A CLIP SPACING OF 24"

						APP
						CHK
						DRW
						DSN
						DRAWING STATUS
						DATE
						BY/DATE/DOI
						#

NOTES

This is a copyright drawing and shall not be reproduced in any form without written permission from Forma Steel

Contractor to check and verify all the dimensions before construction, any errors and omissions shall be reported immediately

Do not scale the drawing

All construction shall be in accordance with latest codes.

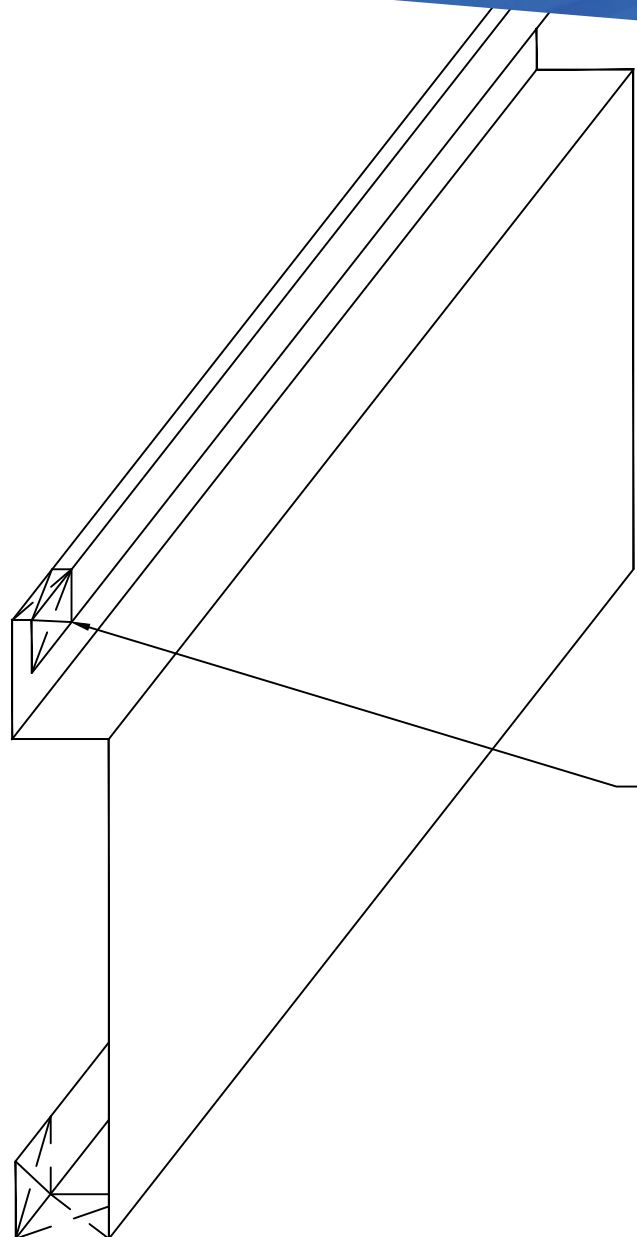

REMOVE 1/2" MATERIAL
WHERE INDICATED ON
UNDER LAP PIECE OF
SPLICE

REMOVE 1/2" MATERIAL
WHERE INDICATED ON
UNDER LAP PIECE OF
SPLICE

NOTE:
-SUBSTRATE MUST BE LEVEL, PLUMB AND IN PLANE.
-INSTALLATION OF CLIPS MUST NOT INDUCE OUTSIDE FORCES INTO THE PANEL
-Z BAR IS STRONGLY RECOMMENDED AS PANEL BACKING TO HELP REDUCE THE CHANCE OF OIL CANNING
-RECOMMENDED SUBSTRATE 1/2" PLYWOOD MINIMUM WITH A CLIP SPACING OF 24"

						APP
						CHK
						DRW
						DSN
						DRAWING STATUS
						DATE [YY/MM/DD]
						#

NOTES

This is a copyright drawing and shall not be reproduced in any form without written permission from Forma Steel

Contractor to check and verify all the dimensions before construction, any errors and omissions shall be reported immediately

Do not scale the drawing

All construction shall be in accordance with latest codes.

SERIES	DRAWING
FORMA STEEL FORMA PLANK	OVERLAP

DATE	SHEET NUMBER
2021	D8

Forma Plank Installation

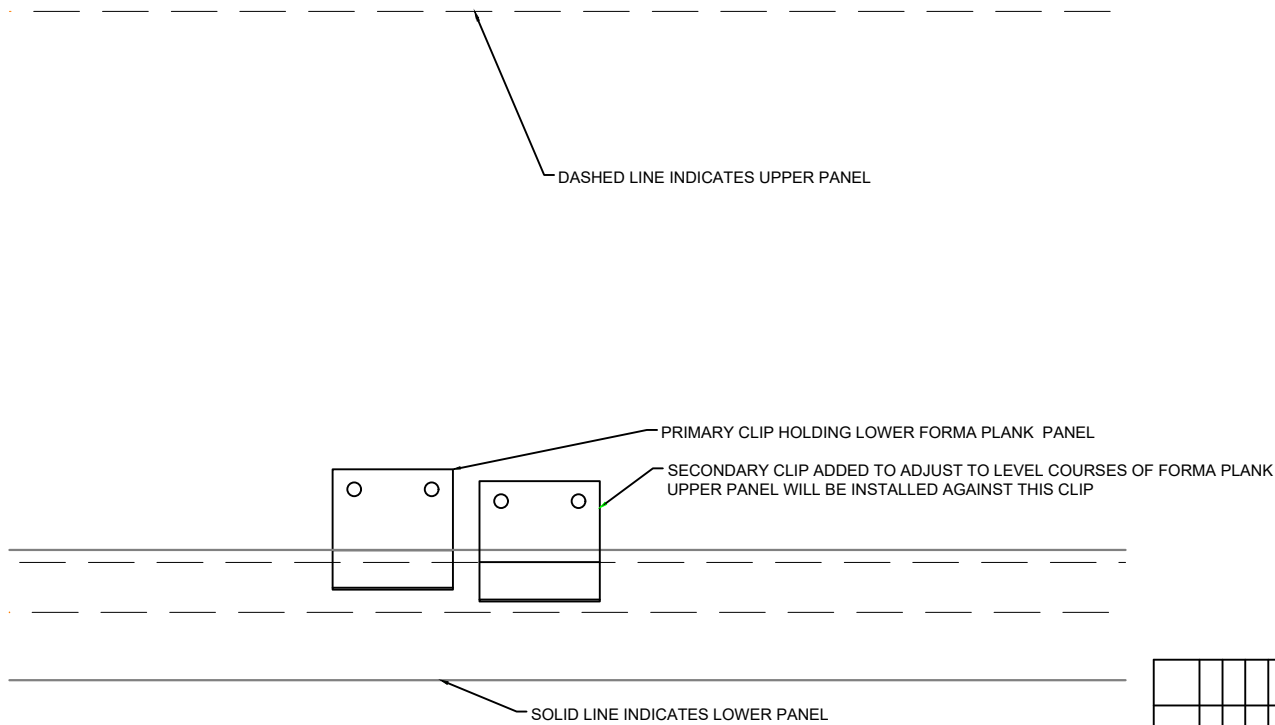

NOTE:
WHEN INSTALLING ANY PANELS ALIGNMENT TOOLS SHOULD BE USED
AND CONFIRMED THROUGHOUT INSTALLATION CHALK LINES,
MEASURING AND SPACERS WILL ALLOW PANELS TO BE INSTALLED
LEVEL.

ADDITIONAL CLIPS MAY BE INSTALLED LOWER THAN PRIMARY CLIPS
TO HELP RE-ALIGN ROWS OF PANELS IF REQUIRED

CLIPS MAY BE REQUIRED TO BE SHIMMED TO ALLOW FOR THE BEST
INSTALLATION.

NOTE:
-SUBSTRATE MUST BE LEVEL, PLUMB
AND IN PLANE.
-INSTALLATION OF CLIPS MUST NOT
INDUCE OUTSIDE FORCES INTO THE
PANEL

						APP
						CHK
						DRW
						DSN
						DRAWING STATUS
						DATE (YYMMDD)
						#

NOTES

This is a copyright
drawing and shall not
be reproduced in any
form without written
permission from Forma
Steel

Contractor to check
and verify all the
dimensions before
construction, any errors
and omissions shall be
reported immediately

Do not scale the
drawing

All construction shall be
in accordance with
latest codes.

SERIES	DRAWING
FORMA STEEL FORMA PLANK	LEVELING CLIPS

DATE	SHEET NUMBER
11-08-2019	D9