

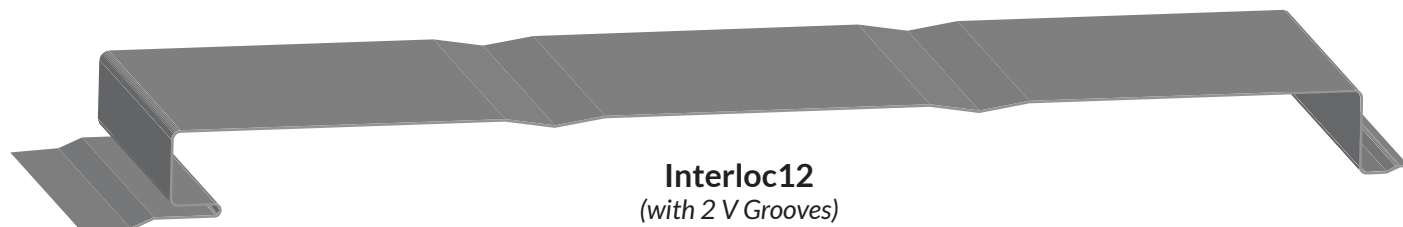

## Interloc Installation



**Interloc12**  
(with 2 V Grooves)



**Interloc8**  
(with V Groove)



**Interloc75 Reveal**  
(with Perforations)

The Interloc Wall & Soffit Panel System is a smooth wall panel that can be installed both horizontally and vertically, and is commonly used as a soffit panel with perforations. This hidden fastener standing seam panel comes in a variety of coverages with options for flush wall or 1/2" reveal.

Depending on the coverage chosen, the Interloc Panel comes in a flat pan, with v grooves, with perforations, or a combination of these options. Available in our Standard 24 gauge colour series, this panel can also be produced in our Woodgrain Series, Textured Series, and PVDF Kynar Colours.

**Interloc Panel Trims:** Refer to our 1" Trim Collection for all trim profiles associated with Interloc Panels.

**Please Note:** Z-Bar is strongly recommended to reduce the chance of oil canning

**Minimum Substrate Recommended:** 1/2" Plywood

**Installation Drawings:** Basic installation drawings are attached to this document. Specific details and further information may be required as per site requirements.

## Obstacle Removal:

Remove downspouts to create a clear workspace for installing the siding. Trees, shrubs and any other objects that could get in the way should also be safely removed. Remove windowsill extensions where necessary.

## Wall Preparation:

Ensure that the surface is even. You may have to shim out low places in the plane of the wall. The working surface should be secured with fasteners, and clear of debris such as old paint, putty or caulking buildup. Make sure the house wrap or water barrier is installed according to building codes before installing the siding over top.

## Product Preparation:

Remove the protective film prior to installation. Review panel lengths in reference to the cut sheet.

## Cutting:

Because the underside is flatter, it is recommended that roofing and siding be cut from this side. A power saw, nibbler, snips or profile shear may be used. Be sure to clean metal filings from off the panels to prevent unsightly stains.

## Storage Instructions:

If the panels are not going to be used immediately, they should be stored in a dry well ventilated area. If it is not possible to store the material inside, block up the panels to allow air movement around the packages. Also raise one side of the bundles to ensure positive draining, and use a good quality cover (other than plastic) anchored loosely to protect the material and still allow ventilation. Store away from aggressive substances and any other materials that could contaminate the surface of the panels.

## Application Precautions:

Metal installed with screw fasteners should be fastened onto a solid backing. Avoid installing directly over green, damp or ACQ lumber, porous insulation or other damaging materials. The use of a moisture barrier (such as Ice & Water Shield) is recommended in such situations. Strong chemicals, fertilizers, manure, some soils, and lime may cause premature deterioration. Installation near such materials is not recommended.

## Warning:

Material is slippery and has sharp edges, use extreme caution when handling or installing. Avoid working with sheet metal products on windy days.

# Interloc Panel Installation

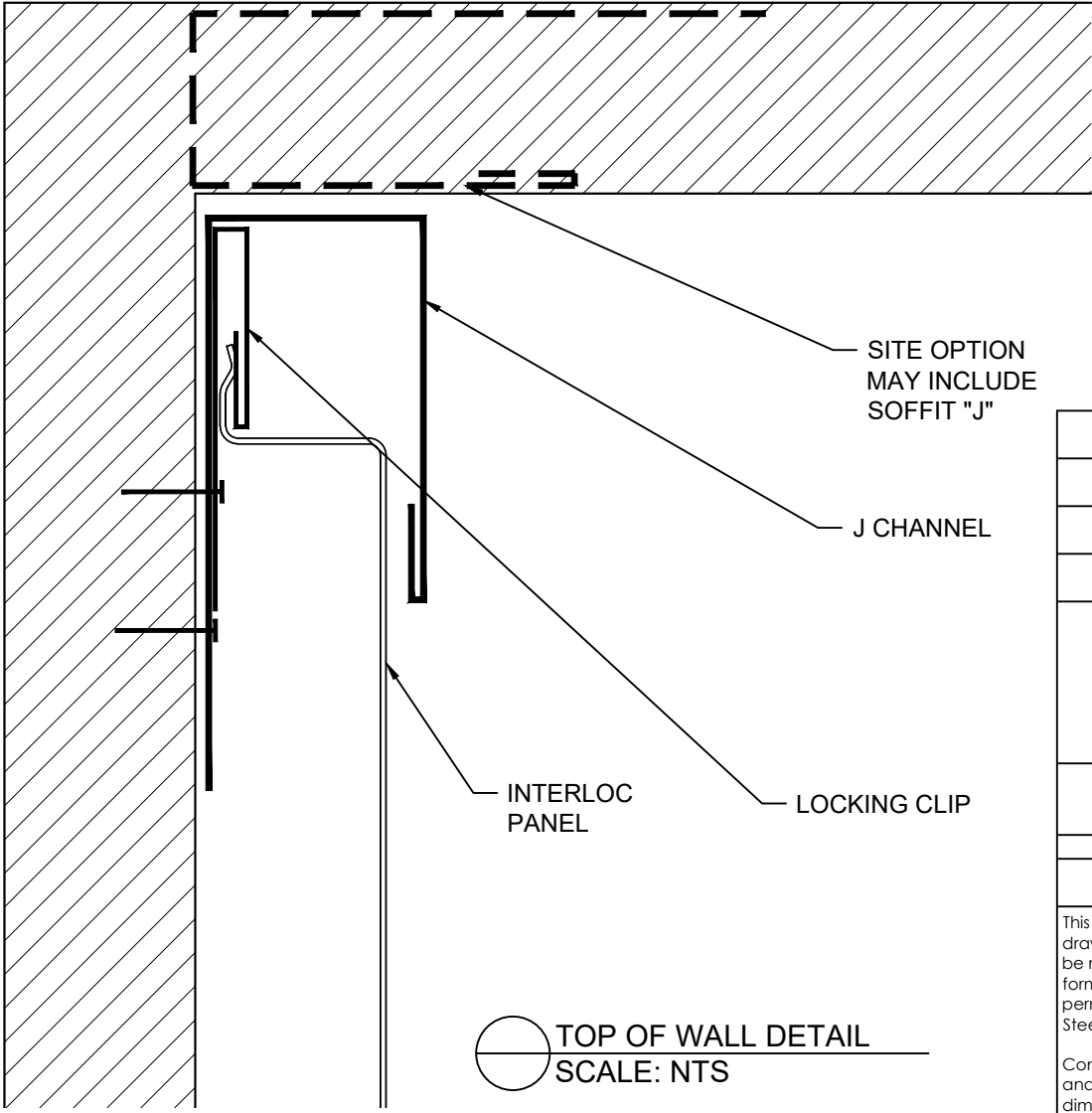

NOTE:  
-SUBSTRATE MUST BE LEVEL, PLUMB AND IN PLANE.  
-INSTALLATION MUST NOT INDUCE OUTSIDE FORCES INTO THE PANEL  
-Z BAR IS STRONGLY RECOMMENDED AS PANEL BACKING TO HELP REDUCE THE CHANCE OF OIL CANNING  
-RECOMMENDED SUBSTRATE  $\frac{1}{2}$ " PLYWOOD MINIMUM

						APP
						CHK
						DRW
						DSN
						DRAWING STATUS
						DATE (YY/MM/DD)
						#

## NOTES

This is a copyright drawing and shall not be reproduced in any form without written permission from Forma Steel

Contractor to check and verify all the dimensions before construction, any errors and omissions shall be reported immediately

Do not scale the drawing

All construction shall be in accordance with latest codes.

SERIES	DRAWING
FORMA STEEL INTERLOC	TOP OF WALL

DATE
2021

SHEET NUMBER
D1

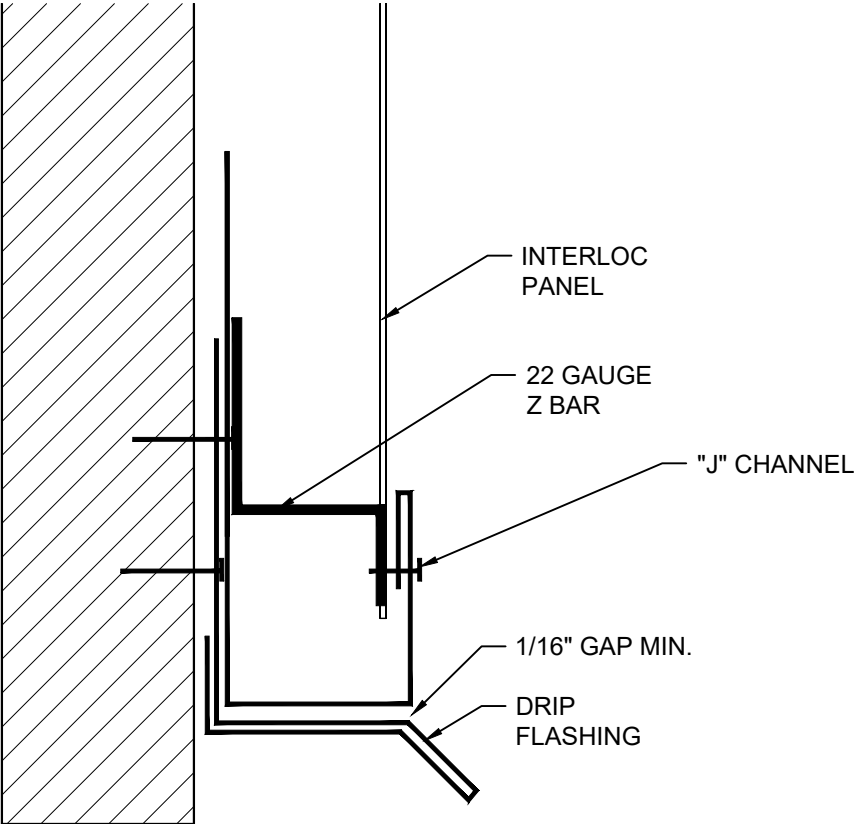

⊕ BOTTOM OF WALL DETAIL  
SCALE: NTS

NOTE:  
-SUBSTRATE MUST BE LEVEL, PLUMB AND IN PLANE.  
-INSTALLATION MUST NOT INDUCE OUTSIDE FORCES INTO THE PANEL  
-Z BAR IS STRONGLY RECOMMENDED AS PANEL BACKING TO HELP REDUCE THE CHANCE OF OIL CANNING  
-RECOMMENDED SUBSTRATE  $\frac{1}{2}$ " PLYWOOD MINIMUM

						APP
						CHK
						DRW
						DSN
						DRAWING STATUS
						DATE (YY/MM/DD)
						#

NOTES

This is a copyright drawing and shall not be reproduced in any form without written permission from Forma Steel

Contractor to check and verify all the dimensions before construction, any errors and omissions shall be reported immediately

Do not scale the drawing

All construction shall be in accordance with latest codes.

SERIES	DRAWING
FORMA STEEL INTERLOC	BASE/DRIP FLASHING

DATE
2021

SHEET NUMBER
D2

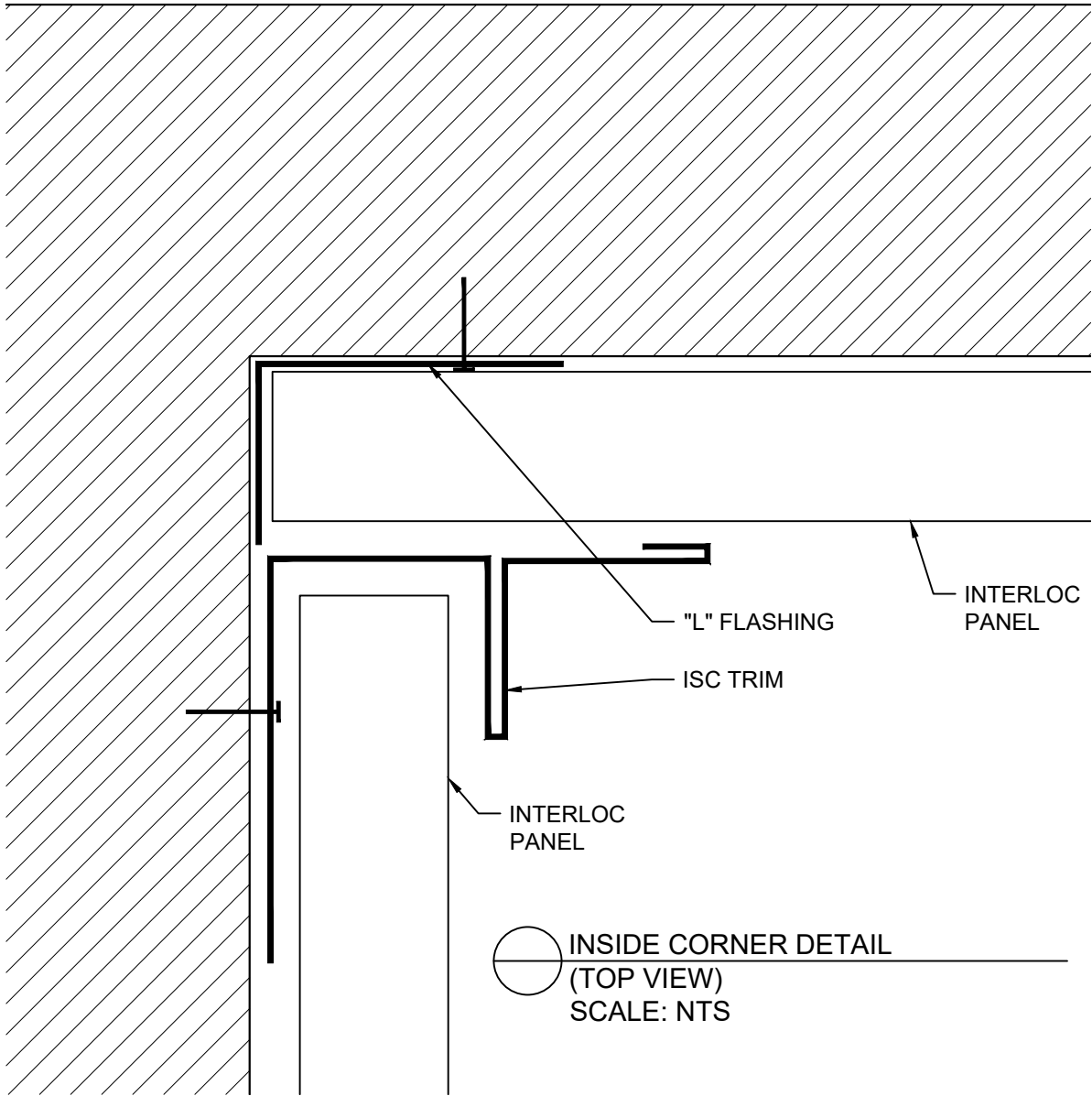

NOTE:  
-SUBSTRATE MUST BE LEVEL, PLUMB AND IN PLANE.  
-INSTALLATION MUST NOT INDUCE OUTSIDE FORCES INTO THE PANEL  
-Z BAR IS STRONGLY RECOMMENDED AS PANEL BACKING TO HELP REDUCE THE CHANCE OF OIL CANNING  
-RECOMMENDED SUBSTRATE  $\frac{1}{2}$ " PLYWOOD MINIMUM

						APP
						CHK
						DRW
						DSN
						DRAWING STATUS
						DATE
						(YYMMDD)
						#

NOTES

This is a copyright drawing and shall not be reproduced in any form without written permission from Forma Steel

Contractor to check and verify all the dimensions before construction, any errors and omissions shall be reported immediately

Do not scale the drawing

All construction shall be in accordance with latest codes.

# Interloc Panel Installation

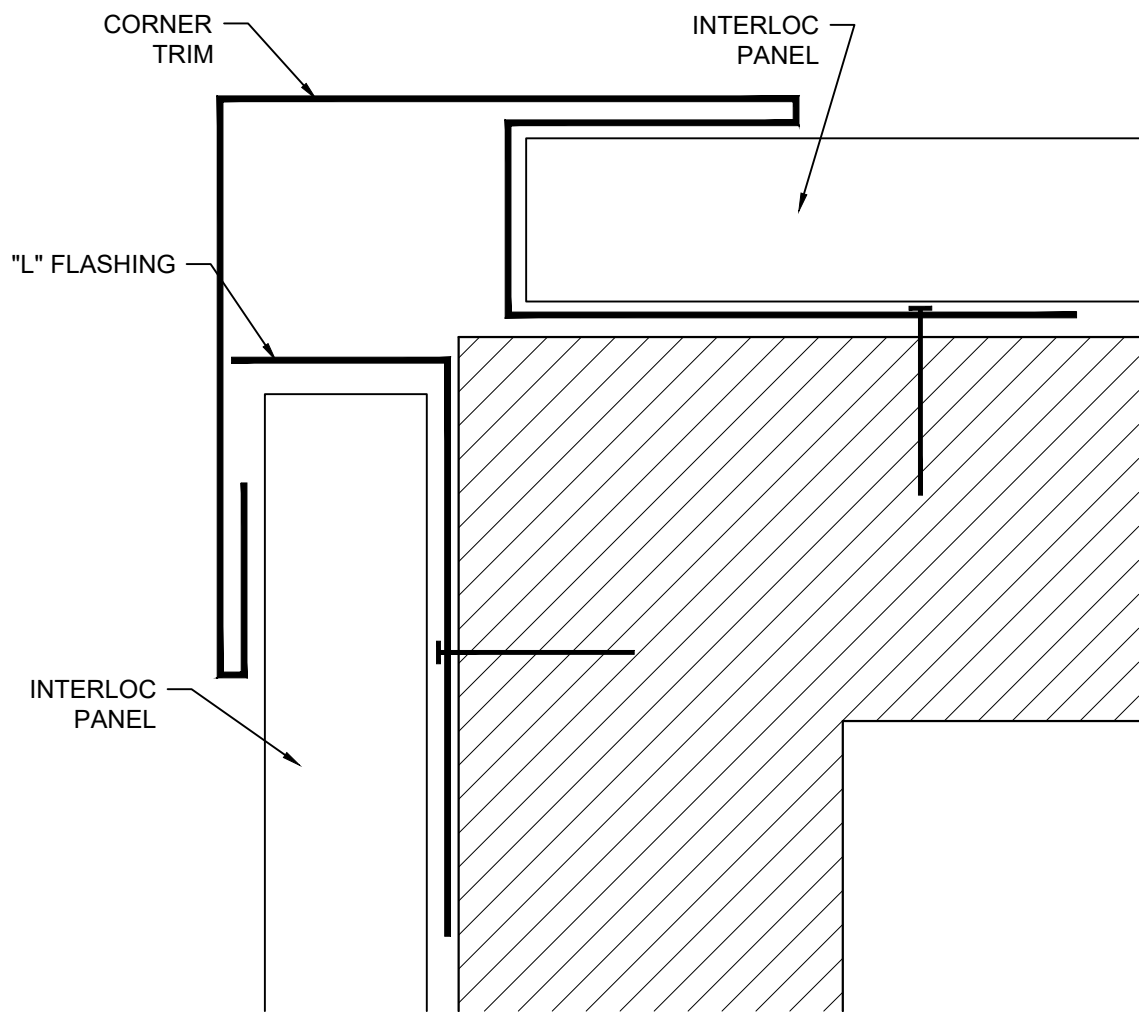

**OUTSIDE CORNER DETAIL**  
**(TOP VIEW)**  
**SCALE: NTS**

**NOTE:**  
 -SUBSTRATE MUST BE LEVEL, PLUMB AND IN PLANE.  
 -INSTALLATION MUST NOT INDUCE OUTSIDE FORCES INTO THE PANEL  
 -Z BAR IS STRONGLY RECOMMENDED AS PANEL BACKING TO HELP REDUCE THE CHANCE OF OIL CANNING  
 -RECOMMENDED SUBSTRATE  $\frac{1}{2}$ " PLYWOOD MINIMUM

					APP
					CHK
					DRW
					DSN
					DRAWING STATUS
					DATE (YY/MM/DD)
					#

## NOTES

This is a copyright drawing and shall not be reproduced in any form without written permission from Forma Steel

Contractor to check and verify all the dimensions before construction, any errors and omissions shall be reported immediately

Do not scale the drawing

All construction shall be in accordance with latest codes.

SERIES	DRAWING
<b>FORMA STEEL INTERLOC</b>	<b>OUTSIDE CORNER</b>

DATE	SHEET NUMBER
2021	<b>D4</b>



# Interloc Panel Installation

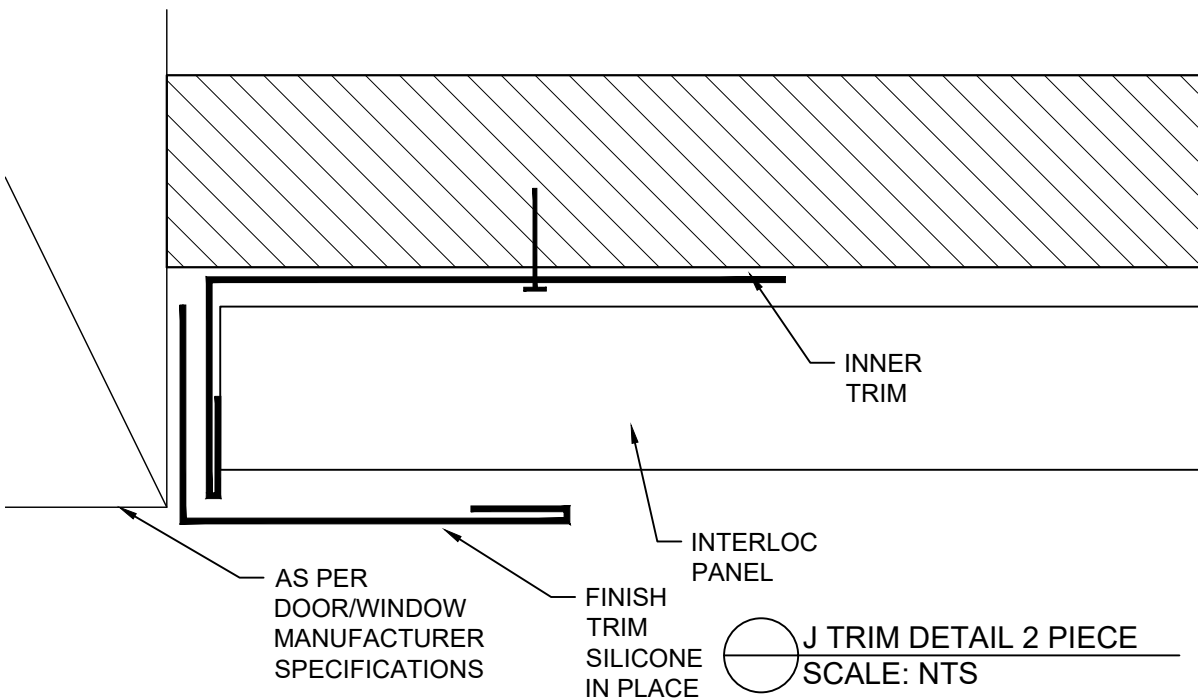
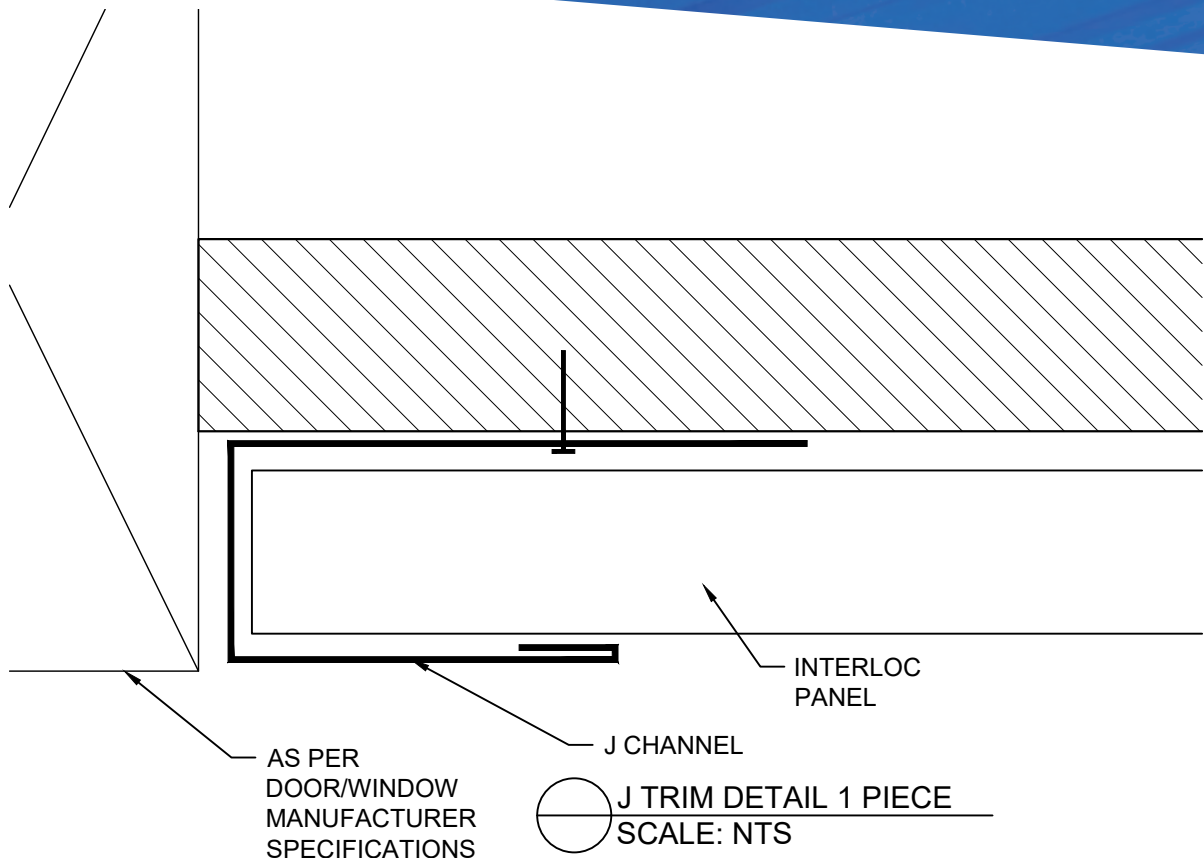

NOTE:  
-SUBSTRATE MUST BE LEVEL, PLUMB AND IN PLANE.  
-INSTALLATION MUST NOT INDUCE OUTSIDE FORCES INTO THE PANEL  
-Z BAR IS STRONGLY RECOMMENDED AS PANEL BACKING TO HELP REDUCE THE CHANCE OF OIL CANNING  
-RECOMMENDED SUBSTRATE  $\frac{1}{2}$ " PLYWOOD MINIMUM

					APP
					CHK
					DRW
					DSN
					DRAWING STATUS
					DATE (YY/MM/DD)
					#

## NOTES

This is a copyright drawing and shall not be reproduced in any form without written permission from Forma Steel

Contractor to check and verify all the dimensions before construction, any errors and omissions shall be reported immediately

Do not scale the drawing

All construction shall be in accordance with latest codes.

# Interloc Panel Installation

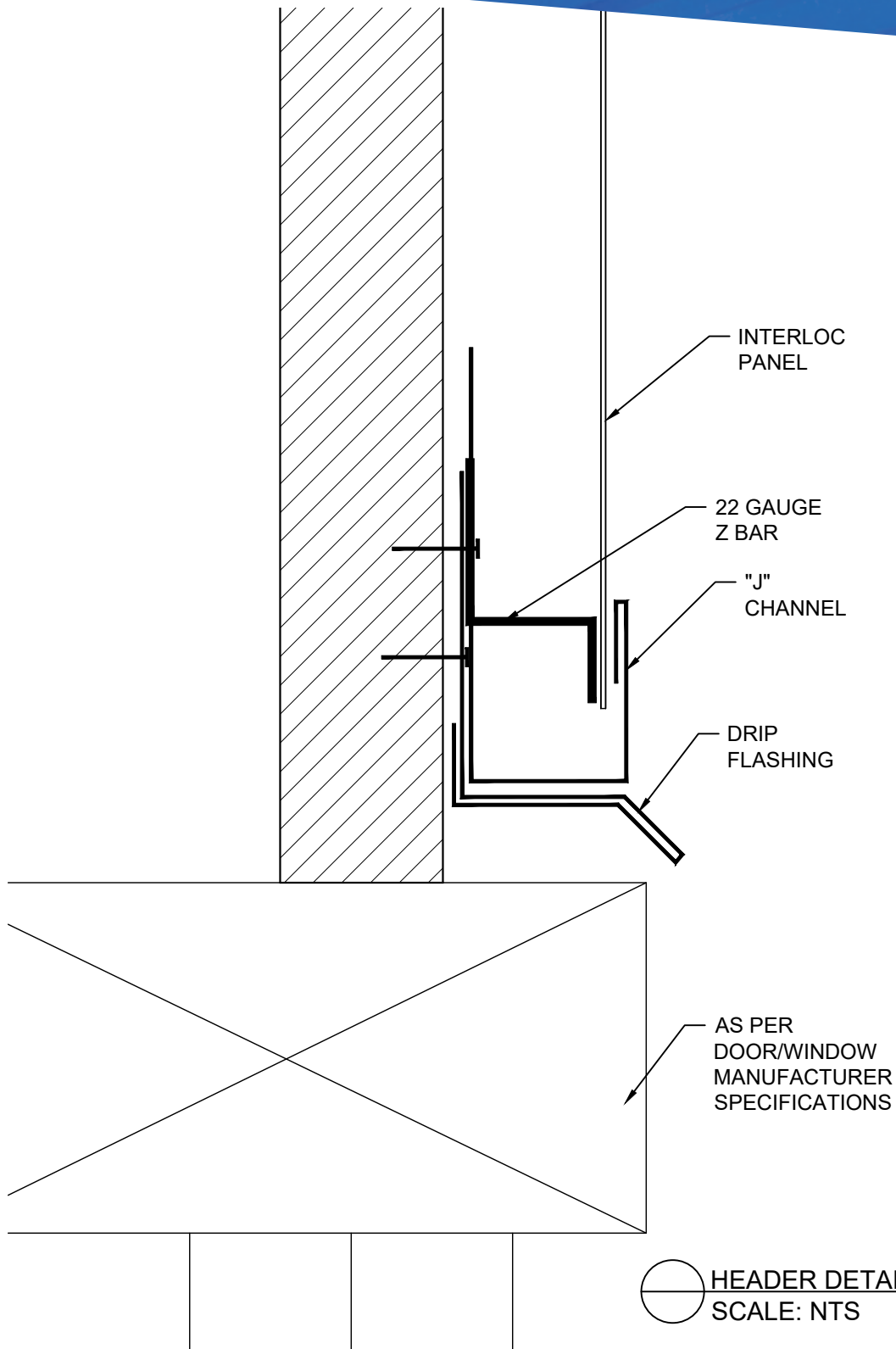

NOTE:  
 -SUBSTRATE MUST BE LEVEL, PLUMB AND IN PLANE.  
 -INSTALLATION MUST NOT INDUCE OUTSIDE FORCES INTO THE PANEL  
 -Z BAR IS STRONGLY RECOMMENDED AS PANEL BACKING TO HELP REDUCE THE CHANCE OF OIL CANNING  
 -RECOMMENDED SUBSTRATE  $\frac{1}{2}$ " PLYWOOD MINIMUM

						APP
						CHK
						DRW
						DSN
						DRAWING STATUS
						DATE (YY/MM/DD)
						#

## NOTES

This is a copyright drawing and shall not be reproduced in any form without written permission from Forma Steel

Contractor to check and verify all the dimensions before construction, any errors and omissions shall be reported immediately

Do not scale the drawing

All construction shall be in accordance with latest codes.

SERIES	DRAWING
FORMA STEEL INTERLOC	HEADER DETAIL

DATE	SHEET NUMBER
2021	D6